

SK - DIN69871

SK - DIN69871



CALETTAMENTO A CALDO STANDARD

SHRINK FIT HOLDERS STANDARD



CALETTAMENTO A CALDO SLIM TYPE

SHRINK FIT HOLDERS SLIM TYPE



PORTAPINZA PER SKS

COLLET CHUCK FOR SKS



PORTA TESTINE FILETTATE (TIPO CPY)

FOR SCREWED MILLING CUTTERS



FORTE SERRAGGIO

POWER MILLING CHUCKS



IDRAULICO

HYDRAULIC EXPANSIONS CHUCK



PORTAPINZA ER DIN6499

COLLET CHUCK FOR ER DIN6499



PORTAPINZA EOC DIN6388

COLLET CHUCK FOR EOC DIN6388



PER FRESE WELDON

END MILL HOLDERS



PORTAFRESE FISSI

SHELL END MILL HOLDERS



PORTAFRESE COMBINATI

COMBI SHELL END MILL HOLDERS



PORTA PUNTE AUTOSERRANTI CON CHIAVE A SETTORE

DRILL CHUCKS WITH HOOK WRENCH



PORTA PUNTE CON CHIAVE ESAGONALE

HEX KEY LOCK DRILL CHUCKS



CONO MORSE PUNTE/ FRESE

MORSE TAPER FOR DRILLS/MILLS



STELO TENERO LAVORABILE

BLANK ARBORS



BARRA DI CONTROLLO

TEST ARBORS

CARATTERISTICHE / SPECIFICATION / CARACTÉRISTIQUES/ TECHNISCHE DATEN

CARATTERISTICHE TECNICHE

- Costruiti in acciaio certificato in barre.
- Eseguiti trattamenti termici da fornitori certificati ISO 9001.
- Rettificati di precisione esternamente, internamente e nelle filettature delle ghiera chiudipinza.
- Controllati con strumenti di misura certificati.
- La tolleranza di precisione dei coni ISO è AT2.
- L'errore di concentricità massimo tra il cono e la sede utensile è di 0.003mm.

TECHNICAL FEATURES

- Manufactured with certificate steel.
- Heat treatments are performed by certified suppliers ISO 9001.
- Precision ground on shanks, inside tapers and collet nut threads.
- Tested with high precision inspection and gaging equipment.
- Taper accuracy of ISO SHANKS lower than AT2.
- The maximum error of concentricity between the cone and the seat of tool is 0.003mm.

CARACTÉRISTIQUES

- Fabriqués en bar d'acier certifié.
- Réalisation du traitement thermique par des fournisseurs certifiés ISO 9001.
- Rectification de précision extérieurement, intérieurement et dans les filetages des écrous serre-pince.
- Contrôlés par des instruments de mesure certifiés.
- La tolérance de précision des cônes ISO est AT2.
- L'erreur de concentricité maximum entre le cône et le siège de l'outil est de 0.003 mm.

MERKMALE

- Gebaut aus zertifiziertem Stabstahl
- Warmbehandlungen von Lieferanten mit Zeugnis ISO 9001
- Genauigkeitgeschliffen aussen, innen und in den Gewinden der Spannmutter für den Zangenverschluss
- Geprüft mit zertifizierten Messinstrumente
- Die Präzisionstoleranz der Konen ISO ist AT2
- Die max konzentrische Abweichung zwischen Konus und Werkzeugsitz ist 0.003 mm

ISTRUZIONI / INSTRUCTIONS / INSTRUCTIONS ET QUOTES / ANWEISUNGEN

ISTRUZIONI

- I mandrini vengono forniti in forma ad o ad/b. nel caso dell'ad/b, il lubrificante passa dai fori presenti sulla flangia. L'operatore dovrà togliere le viti di chiusura che troverà già montate sul mandrino.

INSTRUCTIONS

- The tool holders are provided to form ad or ad/b. in case of ad/b, the lubricant pass from holes on the flange. The operator will have to remove screw closure that he will find on the flange.

INSTRUCTIONS:

- Les mandrins doivent être fournis en forme AD ou AD/B. pour l'AD/B, le lubrifiant passe par les trous présents sur la flange. L'opérateur doit enlever les vis de fermeture qu'il trouvera déjà monté sur le mandrin.

TECHNISCHE DATEN

- Die Spannfutter werden in der form AD oder AD/B geliefert
Im falle von AD/B, fließt der Schmierstoff durch die vorhandenen Bohrungen auf der Flansche

QUOTE DEI CONI DI ATTACCO / QUOTE / QUOTES / ABMESSUNGEN

CONO/TAPER	d1	d2	d3	d6	d8 MAX	L1	a	k	f3
TC30	31,75	M12	13	50	45	47,8	3,2	15,9	35
TCB40	44,45	M16	17	63,55	50	68,4	3,2	15,9	35
TCB45	57,15	M20	21	82,55	63	82,7	3,2	15,9	35
TCB50	69,85	M24	25	97,5	80	101,8	3,2	15,9	35

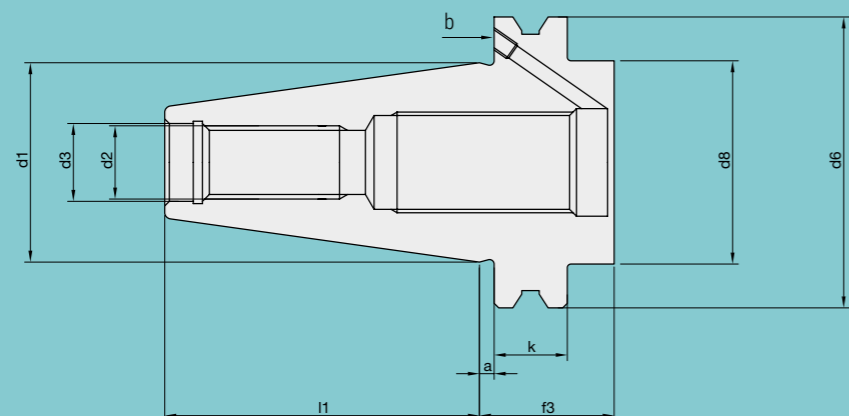

CALETTAMENTO A CALDO STANDARD

SHRINK FIT HOLDERS STANDARD

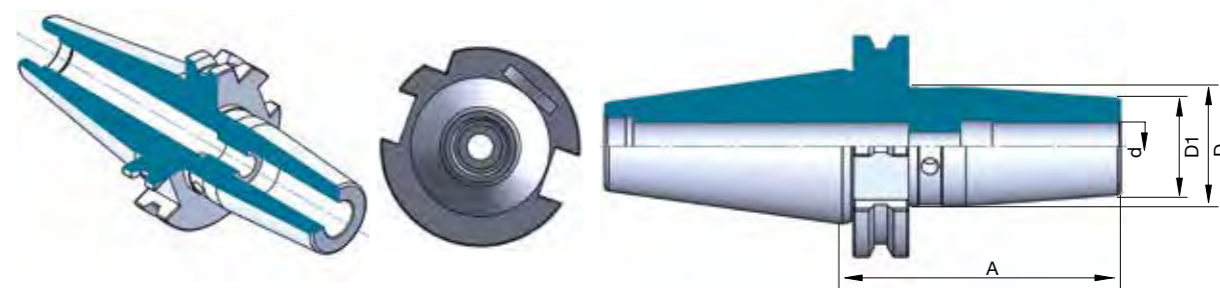
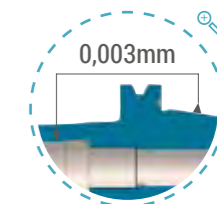

CALETTAMENTO STANDARD - SHRINK FIT HOLDERS STANDARD - SK30

Cod.	TYPE	d	A	AT2		G2.5/25000		AD	
				D1	D	D1	D	D1	D
SK.30.80.CL3	TC30 H80 CL3	3	80	10	20				
SK.30.80.CL4	TC30 H80 CL4	4	80	15	24				
SK.30.80.CL5	TC30 H80 CL5	5	80	15	24				
SK.30.80.CL6	TC30 H80 CL6	6	80	20	27				
SK.30.80.CL8	TC30 H80 CL8	8	80	20	27				
SK.30.80.CL10	TC30 H80 CL10	10	80	24	31				
SK.30.80.CL12	TC30 H80 CL12	12	80	24	31				
SK.30.80.CL14	TC30 H80 CL14	14	80	27	34				
SK.30.80.CL16	TC30 H80 CL16	16	80	27	34				
SK.30.80.CL18	TC30 H80 CL18	18	80	33	40				
SK.30.80.CL20	TC30 H80 CL20	20	80	33	40				

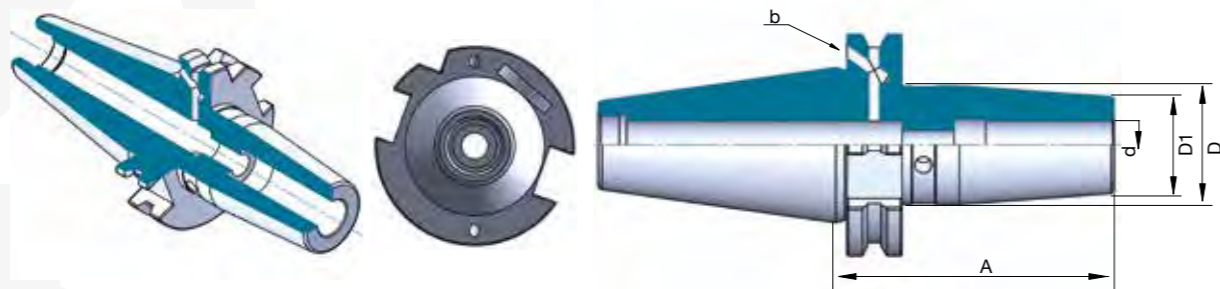

CALETTAMENTO STANDARD - SHRINK FIT HOLDERS STANDARD - SKB40

Cod.	TYPE	d	A	AT2		G2.5/25000		AD/B	
				D1	D	D1	D	D1	D
SKB.40.80.CL3	TCB40 H80 CL3	3	80	10	20				
SKB.40.120.CL3	TCB40 H120 CL3	3	120	10	20				
SKB.40.160.CL3	TCB40 H160 CL3	3	160	10	20				
SKB.40.80.CL4	TCB40 H80 CL4	4	80	15	25				
SKB.40.120.CL4	TCB40 H120 CL4	4	120	15	25				
SKB.40.160.CL4	TCB40 H160 CL4	4	160	15	25				
SKB.40.80.CL5	TCB40 H80 CL5	5	80	15	25				
SKB.40.120.CL5	TCB40 H120 CL5	5	120	15	25				
SKB.40.160.CL5	TCB40 H160 CL5	5	160	15	25				
SKB.40.80.CL6	TCB40 H80 CL6	6	80	21	27				
SKB.40.130.CL6	TCB40 H130 CL6	6	130	21	27				
SKB.40.160.CL6	TCB40 H160 CL6	6	160	21	27				
SKB.40.80.CL8	TCB40 H80 CL8	8	80	21	27				
SKB.40.130.CL8	TCB40 H130 CL8	8	130	21	27				
SKB.40.160.CL8	TCB40 H160 CL8	8	160	21	27				
SKB.40.80.CL10	TCB40 H80 CL10	10	80	24	32				
SKB.40.130.CL10	TCB40 H130 CL10	10	130	24	32				
SKB.40.160.CL10	TCB40 H160 CL10	10	160	24	32				
SKB.40.80.CL12	TCB40 H80 CL12	12	80	24	32				
SKB.40.130.CL12	TCB40 H130 CL12	12	130	24	32				
SKB.40.160.CL12	TCB40 H160 CL12	12	160	24	32				
SKB.40.80.CL14	TCB40 H80 CL14	14	80	27	34				
SKB.40.130.CL14	TCB40 H130 CL14	14	130	27	34				
SKB.40.160.CL14	TCB40 H160 CL14	14	160	27	34				
SKB.40.80.CL16	TCB40 H80 CL16	16	80	27	34				
SKB.40.130.CL16	TCB40 H130 CL16	16	130	27	34				
SKB.40.160.CL16	TCB40 H160 CL16	16	160	27	34				
SKB.40.80.CL18	TCB40 H80 CL18	18	80	33	42				
SKB.40.130.CL18	TCB40 H130 CL18	18	130	33	42				
SKB.40.160.CL18	TCB40 H160 CL18	18	160	33	42				
SKB.40.80.CL20	TCB40 H80 CL20	20	80	33	42				
SKB.40.130.CL20	TCB40 H130 CL20	20	130	33	42				
SKB.40.160.CL20	TCB40 H160 CL20	20	160	33	42				
SKB.40.100.CL25	TCB40 H100 CL25	25	100	44	53				
SKB.40.130.CL25	TCB40 H130 CL25	25	130	44	53				
SKB.40.160.CL25	TCB40 H160 CL25	25	160	44	53				
SKB.40.100.CL32	TCB40 H100 CL32	32	100	44	53				
SKB.40.130.CL32	TCB40 H130 CL32	32	130	44	53				
SKB.40.160.CL32	TCB40 H160 CL32	32	160	44	53				

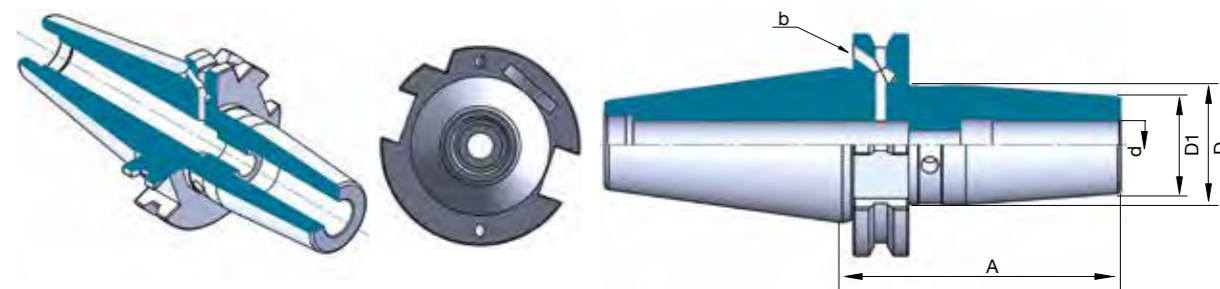

CALETTAMENTO STANDARD - SHRINK FIT HOLDERS STANDARD - SKB50

Cod.	TYPE	d	A	AT2		G2.5/25000		AD/B	
				D1	D	D1	D	D1	D
SKB.50.80.CL3	TCB50 H80 CL3	3	80	10	20				
SKB.50.120.CL3	TCB50 H120 CL3	3	120	10	20				
SKB.50.160.CL3	TCB50 H160 CL3	3	160	10	20				
SKB.50.80.CL4	TCB50 H80 CL4	4	80	15	25				
SKB.50.120.CL4	TCB50 H120 CL4	4	120	15	22				
SKB.50.160.CL4	TCB50 H160 CL4	4	160	15	22				
SKB.50.80.CL5	TCB50 H80 CL5	5	80	15	25				
SKB.50.120.CL5	TCB50 H120 CL5	5	120	15	22				
SKB.50.160.CL5	TCB50 H160 CL5	5	160	15	22				
SKB.50.80.CL6	TCB50 H80 CL6	6	80	20	27				
SKB.50.120.CL6	TCB50 H120 CL6	6	120	20	27				
SKB.50.160.CL6	TCB50 H160 CL6	6	160	20	27				
SKB.50.80.CL8	TCB50 H80 CL8	8	80	20	27				
SKB.50.120.CL8	TCB50 H120 CL8	8	120	20	27				
SKB.50.160.CL8	TCB50 H160 CL8	8	160	20	27				
SKB.50.80.CL10	TCB50 H80 CL10	10	80	24	31				
SKB.50.120.CL10	TCB50 H120 CL10	10	120	24	31				
SKB.50.160.CL10	TCB50 H160 CL10	10	160	24	31				
SKB.50.80.CL12	TCB50 H80 CL12	12	80	24	31				
SKB.50.120.CL12	TCB50 H120 CL12	12	120	24	31				
SKB.50.160.CL12	TCB50 H160 CL12	12	160	24	31				
SKB.50.80.CL14	TCB50 H80 CL14	14	80	27	34				
SKB.50.120.CL14	TCB50 H120 CL14	14	120	27	34				
SKB.50.160.CL14	TCB50 H160 CL14	14	160	27	34				
SKB.50.80.CL16	TCB50 H80 CL16	16	80	27	34				
SKB.50.120.CL16	TCB50 H120 CL16	16	120	27	34				
SKB.50.160.CL16	TCB50 H160 CL16	16	160	27	34				
SKB.50.80.CL18	TCB50 H80 CL18	18	80	33	40				
SKB.50.120.CL18	TCB50 H120 CL18	18	120	33	40				
SKB.50.160.CL18	TCB50 H160 CL18	18	160	33	40				
SKB.50.80.CL20	TCB50 H80 CL20	20	80	33	40				
SKB.50.120.CL20	TCB50 H120 CL20	20	120	33	40				
SKB.50.160.CL20	TCB50 H160 CL20	20	160	33	40				
SKB.50.100.CL25	TCB50 H100 CL25	25	100	44	53				
SKB.50.120.CL25	TCB50 H120 CL25	25	120	44	53				
SKB.50.160.CL25	TCB50 H160 CL25	25	160	44	53				
SKB.50.100.CL32	TCB50 H100 CL32	32	100	44	53				
SKB.50.120.CL32	TCB50 H120 CL32	32	120	44	53				
SKB.50.160.CL32	TCB50 H160 CL32	32	160	44	53				

CALETTAMENTO A CALDO SLIM TYPE

SHRINK FIT HOLDERS SLIM TYPE

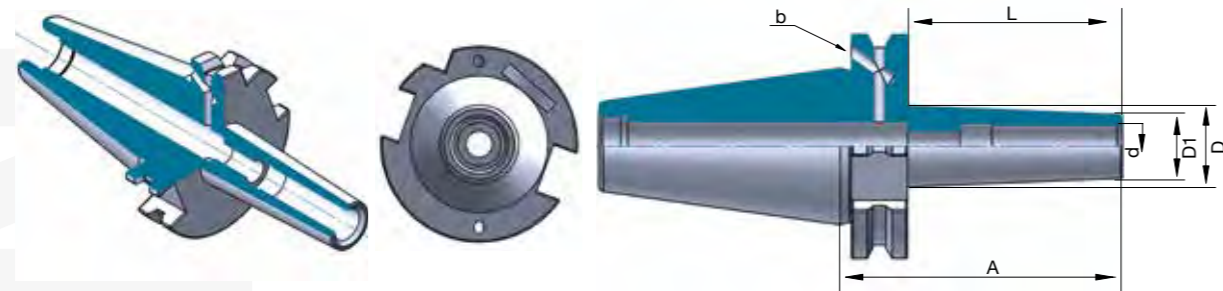
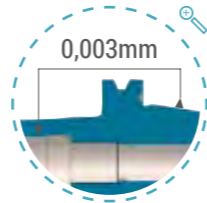

CALETTAMENTO TIPO SLIM - SHRINK FIT HOLDERS SLIM TYPE - SKB40

Cod.	TYPE	d	A	AT2		G2.5/25000		AD/B
				D1	D	D1	D	
SKB.40.80.CL3.SL	SLIM TYPE TCB40 H80 CL3	3	80	9	13	9	13	52
SKB.40.120.CL3.SL	SLIM TYPE TCB40 H120 CL3	3	120	9	16	9	16	92
SKB.40.80.CL4.SL	SLIM TYPE TCB40 H80 CL4	4	80	10	15	10	15	52
SKB.40.120.CL4.SL	SLIM TYPE TCB40 H120 CL4	4	120	10	20	10	20	92
SKB.40.80.CL5.SL	SLIM TYPE TCB40 H80 CL5	5	80	11	16	11	16	52
SKB.40.120.CL5.SL	SLIM TYPE TCB40 H120 CL5	5	120	11	20	11	20	92
SKB.40.80.CL6.SL	SLIM TYPE TCB40 H80 CL6	6	80	12	17	12	17	60,9
SKB.40.130.CL6.SL	SLIM TYPE TCB40 H130 CL6	6	130	12	19	12	19	110,9
SKB.40.160.CL6.SL	SLIM TYPE TCB40 H160 CL6	6	160	12	19	12	19	140,9
SKB.40.80.CL8.SL	SLIM TYPE TCB40 H80 CL8	8	80	14	19	14	19	60,9
SKB.40.130.CL8.SL	SLIM TYPE TCB40 H130 CL8	8	130	14	21	14	21	110,9

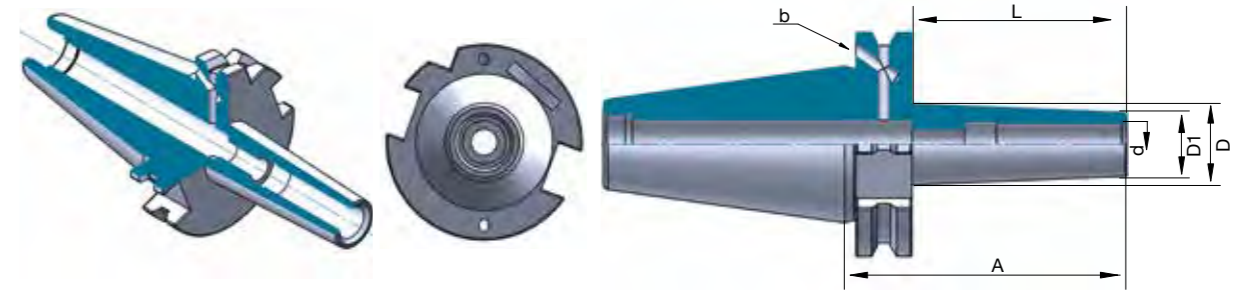

CALETTAMENTO TIPO SLIM - SHRINK FIT HOLDERS SLIM TYPE - SKB40

Cod.	TYPE	d	A	AT2		G2.5/25000		AD/B
				D1	D	D1	D	
SKB.40.160.CL8.SL	SLIM TYPE TCB40 H160 CL8	8	160	14	21	14	21	140,9
SKB.40.80.CL10.SL	SLIM TYPE TCB40 H80 CL10	10	80	16	21	16	21	60,9
SKB.40.130.CL10.SL	SLIM TYPE TCB40 H130 CL10	10	130	16	23	16	23	110,9
SKB.40.160.CL10.SL	SLIM TYPE TCB40 H160 CL10	10	160	16	23	16	23	140,9
SKB.40.80.CL12.SL	SLIM TYPE TCB40 H80 CL12	12	80	18	23	18	23	60,9
SKB.40.130.CL12.SL	SLIM TYPE TCB40 H130 CL12	12	130	18	25	18	25	110,9
SKB.40.160.CL12.SL	SLIM TYPE TCB40 H160 CL12	12	160	18	25	18	25	140,9
SKB.40.80.CL14.SL	SLIM TYPE TCB40 H80 CL14	14	80	22	25	22	25	60,9
SKB.40.130.CL14.SL	SLIM TYPE TCB40 H130 CL14	14	130	22	27	22	27	110,9
SKB.40.160.CL14.SL	SLIM TYPE TCB40 H160 CL14	14	160	22	27	22	27	140,9
SKB.40.80.CL16.SL	SLIM TYPE TCB40 H80 CL16	16	80	24	29	24	29	60,9
SKB.40.130.CL16.SL	SLIM TYPE TCB40 H130 CL16	16	130	24	31	24	31	110,9
SKB.40.160.CL16.SL	SLIM TYPE TCB40 H160 CL16	16	160	24	31	24	31	140,9
SKB.40.80.CL20.SL	SLIM TYPE TCB40 H80 CL20	20	80	32	39	32	39	60,9
SKB.40.130.CL20.SL	SLIM TYPE TCB40 H130 CL20	20	130	32	39	32	39	110,9
SKB.40.160.CL20.SL	SLIM TYPE TCB40 H160 CL20	20	160	32	39	32	39	140,9

PORTAPINZA PER SKS

COLLET CHUCK FOR SKS

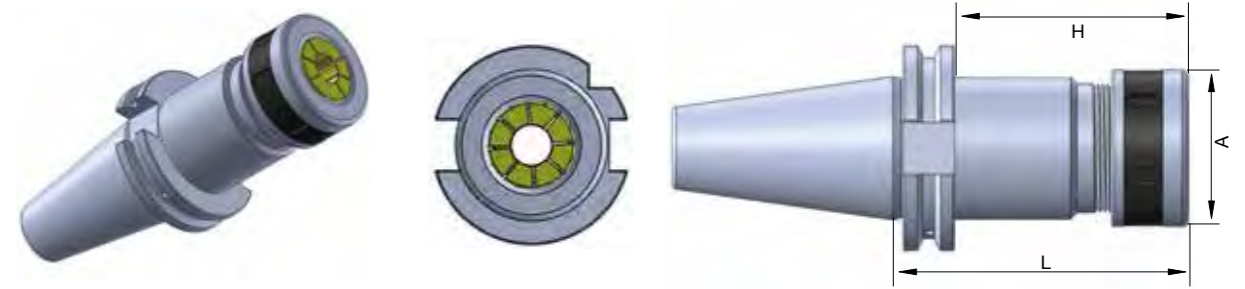
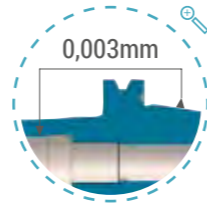

PORTAPINZA PER SKS - COLLET CHUCKS FOR SKS - SK50

Cod.	TYPE	H	SK50		
			AT2	G2.5/25000	AD
SK.50.105.SKS10	TC50 H105 SKS10	70	L	A	
SK.50.165.SKS10	TC50 H165 SKS10	130	L	A	
SK.50.105.SKS20	TC50 H105 SKS20	80	L	A	
SK.50.165.SKS20	TC50 H165 SKS20	140	L	A	

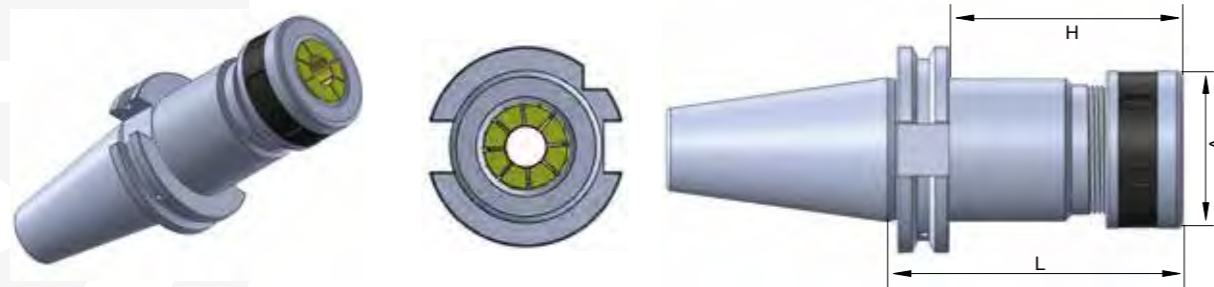

PORTAPINZA PER SKS - COLLET CHUCKS FOR SKS - SK40

Cod.	TYPE	H	SK40		
			AT2	G2.5/25000	AD
SK.40.90.SKS10	TC40 H90 SKS10	52	L	A	
SK.40.120.SKS10	TC40 H120 SKS10	82	L	A	
SK.40.90.SKS20	TC40 H90 SKS20	70	L	A	
SK.40.120.SKS20	TC40 H120 SKS20	100	L	A	

PORTA TESTINE FILETTATE (TIPO CPY)

TOOLHOLDERS FOR SCREWED MILLING CUTTERS

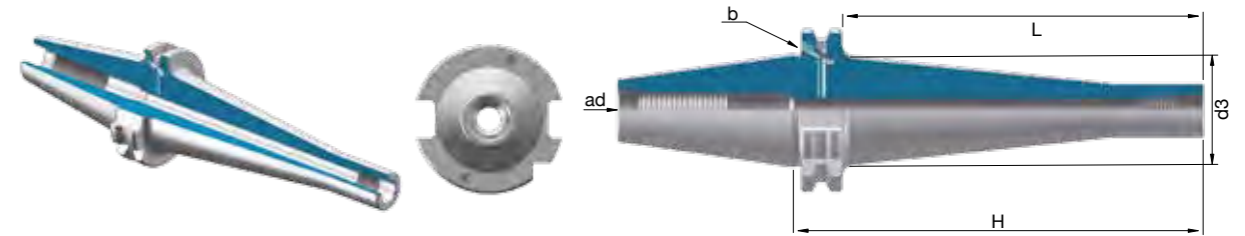
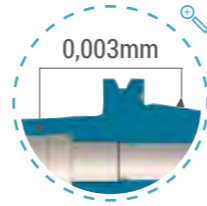

PORTA TESTINE FILETTATE - FOR SCREWED MILLING CUTTER - SKB40

Cod.	TYPE	M	d1	AT2			L	H
				d2	d3	AD/B		
SKB.40.75.M12CPY	TCB40 H 75 M12 CPY	M12	12,5	21	24	56	75	
SKB.40.95.M12CPY	TCB40 H 95 M12 CPY	M12	12,5	21	31	76	95	
SKB.40.115.M12CPY	TCB40 H115 M12 CPY	M12	12,5	21	31	96	115	
SKB.40.145.M12CPY	TCB40 H145 M12 CPY	M12	12,5	21	38	126	145	
SKB.40.175.M12CPY	TCB40 H175 M12 CPY	M12	12,5	21	42	156	175	
SKB.40.55.M16CPY	TCB40 H 55 M16 CPY	M16	17	29	34	36	55	
SKB.40.75.M16CPY	TCB40 H 75 M16 CPY	M16	17	29	34	56	75	
SKB.40.95.M16CPY	TCB40 H 95 M16 CPY	M16	17	29	34	76	95	
SKB.40.115.M16CPY	TCB40 H115 M16 CPY	M16	17	29	39	96	115	
SKB.40.145.M16CPY	TCB40 H145 M16 CPY	M16	17	29	39	126	145	
SKB.40.175.M16CPY	TCB40 H175 M16 CPY	M16	17	29	39	156	175	

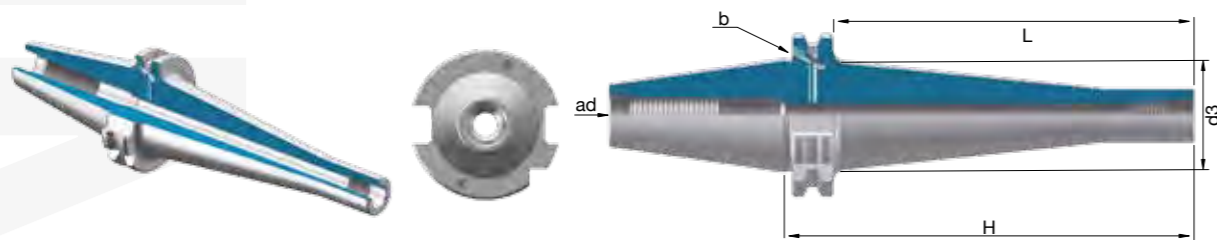

PORTA TESTINE FILETTATE - FOR SCREWED MILLING CUTTER - SKB40

Cod.	TYPE	M	d1	AT2			L	H
				d2	d3	AD/B		
SKB.40.44.M6CPY	TCB40 H 44 M 6 CPY	M6	6,5	10	13	25	44	
SKB.40.69.M6CPY	TCB40 H 69 M 6 CPY	M6	6,5	10	20	50	69	
SKB.40.94.M6CPY	TCB40 H 94 M 6 CPY	M6	6,5	10	23	75	94	
SKB.40.55.M8CPY	TCB40 H 55 M 8 CPY	M8	8,5	13	15	36	55	
SKB.40.75.M8CPY	TCB40 H 75 M 8 CPY	M8	8,5	13	23	56	75	
SKB.40.95.M8CPY	TCB40 H 95 M 8 CPY	M8	8,5	13	23	76	95	
SKB.40.115.M8CPY	TCB40 H115 M 8 CPY	M8	8,5	13	25	96	115	
SKB.40.55.M10CPY	TCB40 H 55 M10 CPY	M10	10,5	18	20	36	55	
SKB.40.75.M10CPY	TCB40 H 75 M10 CPY	M10	10,5	18	25	56	75	
SKB.40.95.M10CPY	TCB40 H 95 M10 CPY	M10	10,5	18	28	76	95	
SKB.40.105.M10CPY	TCB40 H115 M10 CPY	M10	10,5	18	28	96	115	
SKB.40.145.M10CPY	TCB40 H145 M10 CPY	M10	10,5	18	34	126	145	
SKB.40.55.M12CPY	TCB40 H 55 M12 CPY	M12	12,5	21	24	36	55	

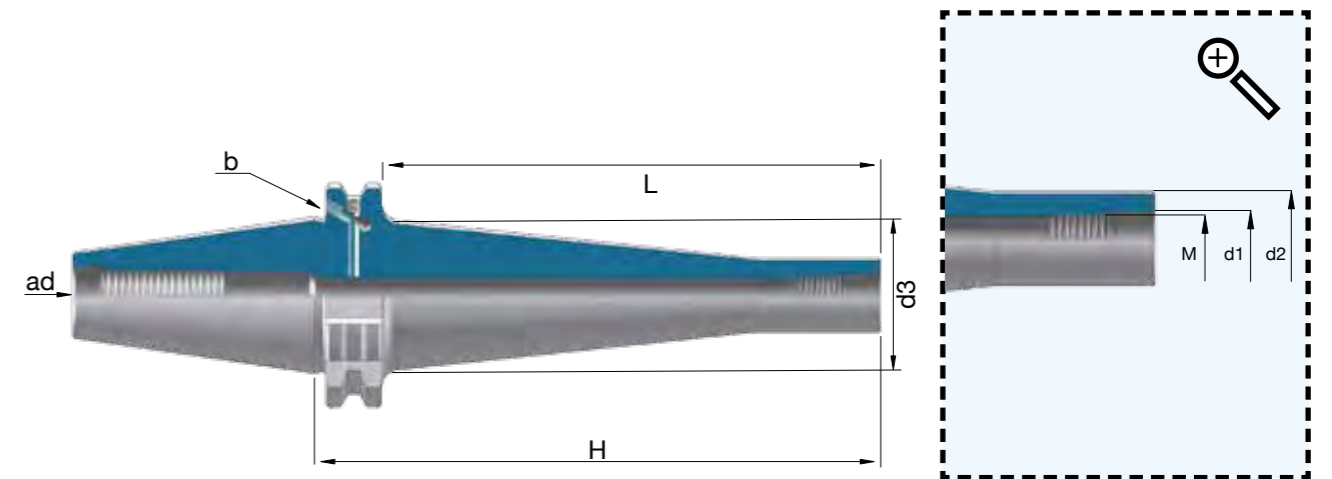

FORTE SERRAGGIO

POWER MILLING CHUCKS

SK-DIN69871

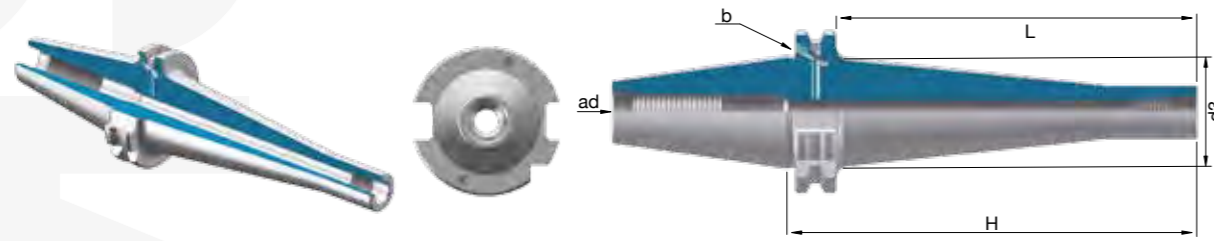

PORTA TESTINE FILETTATE - FOR SCREWED MILLIN CUTTER - SKB50

Cod.	TYPE	M	d1	d2	d3	L	H	AT2	G2.5/25000	AD/B
SKB.50.69.M8CPY	TCB50 H 69 M8 CPY	M8	8,5	13	23	50	69			
SKB.50.119.M8CPY	TCB50 H 119 M8 CPY	M8	8,5	13	25	100	119			
SKB.50.169.M8CPY	TCB50 H 169 M8 CPY	M8	8,5	13	30	150	169			
SKB.50.85.M10CPY	TCB50 H 85 M10 CPY	M10	10,5	18	23	50	85			
SKB.50.135.M10CPY	TCB50 H 135 M10 CPY	M10	10,5	18	32	100	135			
SKB.50.185.M10CPY	TCB50 H 185 M10 CPY	M10	10,5	18	36.5	150	185			
SKB.50.85.M12CPY	TCB50 H 85 M12 CPY	M12	12,5	21	24	50	85			
SKB.50.135.M12CPY	TCB50 H 135 M12 CPY	M12	12,5	21	33	100	125			
SKB.50.185.M12CPY	TCB50 H 185 M12 CPY	M12	12,5	21	40	150	185			
SKB.50.85.M16CPY	TCB50 H 85 M16 CPY	M16	17	29	34	50	85			
SKB.50.135.M16CPY	TCB50 H 135 M16 CPY	M16	17	29	36	100	135			
SKB.50.185.M16CPY	TCB50 H 185 M16 CPY	M16	17	29	42.5	150	185			

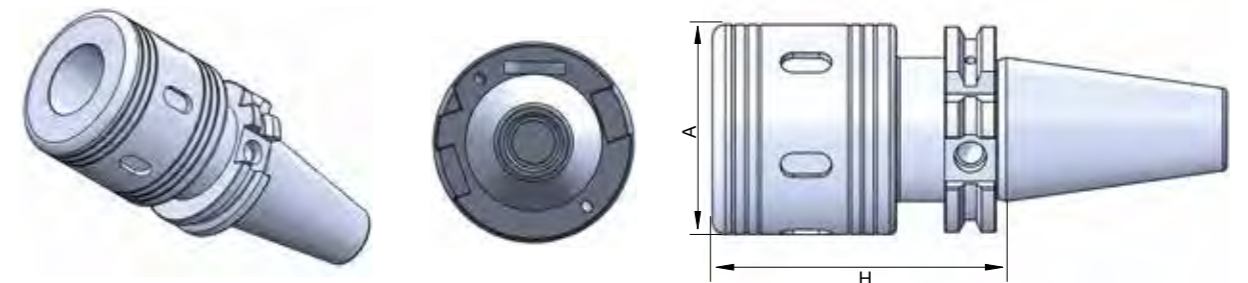
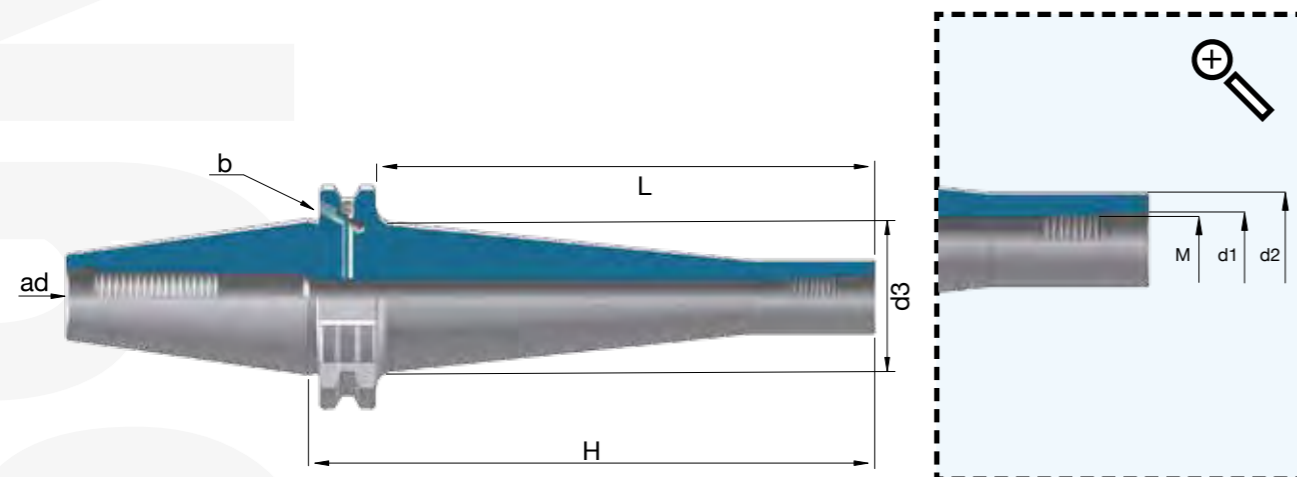
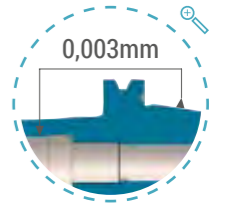

FORTE SERRAGGIO - POWER MILLING CHUCK - SKB40

Cod.	TYPE	A	H	PINZE	AT2	G6.3/15000	AD/B
SKB.40.75.FP20	TCB40 H75 D20	46	75	4SR20 - Ø 3 al Ø18			
SKB.40.95.FP32	TCB40 H95 D32	62	95	4SR32 - Ø 6 al Ø25			

IDRAULICO

HYDRAULIC EXPANSIONS CHUCK

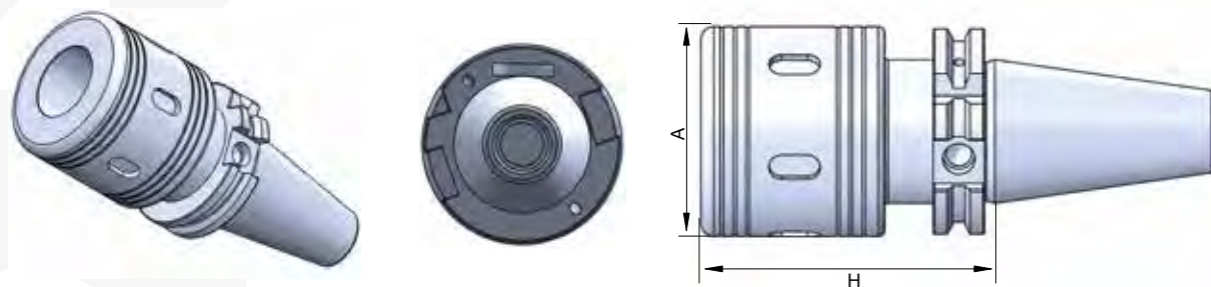

FORTE SERRAGGIO - POWER MILLING CHUCK - SKB50

Cod.	TYPE	A	H	PINZE	AT2	G6.3/15000	AD/B
SKB.50.85.FP20	TCB50 H85 D20	46	85	4SR20 - Ø 3 al Ø18			
SKB.50.85.FP32	TCB50 H85 D32	62	85	4SR32 - Ø 6 al Ø25			

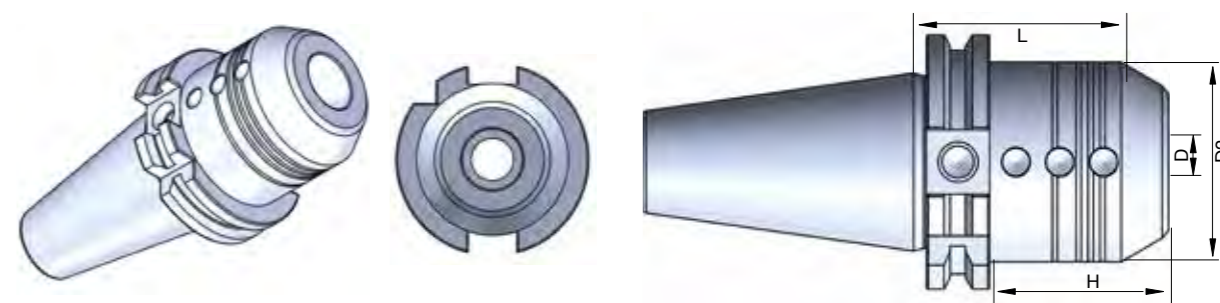
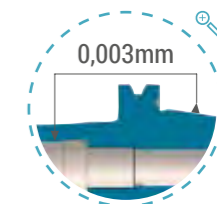

IDRAULICO - HYDRAULIC EXPANSIONS CHUCK - SKB40 - SKB50

Cod.	TYPE	L	H	D2	D	AT2	G6.3/15000	AD/B
SKB.40.77.HY12	TCB40 H77 D12	77	58	32	12			
SKB.40.82.HY20	TCB40 H82 D20	82	63	42	20			
SKB.40.117.HY25	TCB40 H117 D25	117	98	50	25			
SKB.40.117.HY32	TCB40 H117 D32	117	98	60	32			
SKB.50.82.HY20	TCB50 H82 D20	82	63	42	20			
SKB.50.91.HY32	TCB50 H91 D32	91	72	60	32			

PORTAPINZA ER DIN6499

COLLET CHUCK FOR ER DIN6499

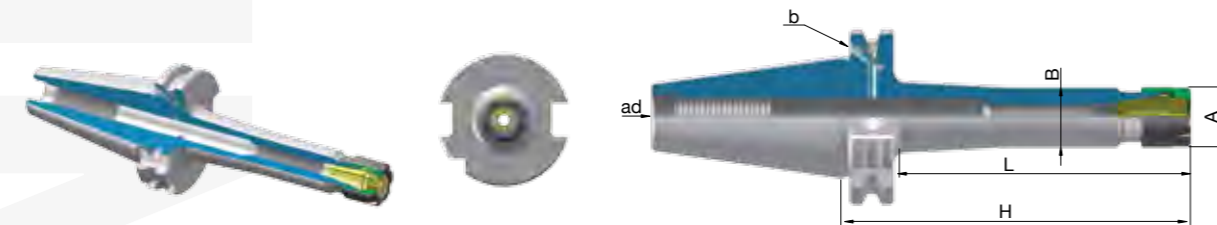
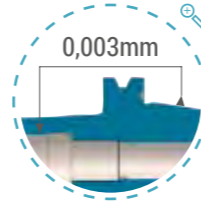

PORTAPINZA ER MINI - COLLET CHUCK ER MINI - SKB40

Cod.	TYPE	CAPACITÀ RANGE	AT2				G6.3/15000			AD/B	
			A	B	L	H	A	B	L	H	
SKB.40.130.ER8M	TCB40 H130 ERX8M	1 ÷ 5 mm	12	12	110,9	130					
SKB.40.100.ER11M	TCB40 H100 ERX11M	1 ÷ 7 mm	16	16	80,9	100					
SKB.40.125.ER11M	TCB40 H125 ERX11M	1 ÷ 7 mm	16	16	105,9	125					
SKB.40.150.ER11M	TCB40 H150 ERX11M	1 ÷ 7 mm	16	16	130,9	150					
SKB.40.70.ER16M	TCB40 H 70 ERX16M	1 ÷ 10 mm	22	22	50,9	70					
SKB.40.100.ER16M	TCB40 H100 ERX16M	1 ÷ 10 mm	22	22	80,9	100					
SKB.40.125.ER16M	TCB40 H125 ERX16M	1 ÷ 10 mm	22	22	105,9	125					
SKB.40.150.ER16M	TCB40 H150 ERX16M	1 ÷ 10 mm	22	22	130,9	150					
SKB.40.100.ER20M	TCB40 H100 ERX20M	1 ÷ 13 mm	28	28	80,9	100					
SKB.40.135.ER20M	TCB40 H135 ERX20M	1 ÷ 13 mm	28	28	115,9	135					
SKB.40.150.ER20M	TCB40 H150 ERX20M	1 ÷ 13 mm	28	28	130,9	150					
SKB.40.100.ER25M	TCB40 H100 ERX25M	1 ÷ 16 mm	35	30	80,9	100					
SKB.40.150.ER25M	TCB40 H150 ERX25M	1 ÷ 16 mm	35	30	130,9	150					
SKB.40.200.ER25M	TCB40 H200 ERX25M	1 ÷ 16 mm	35	30	180,9	200					

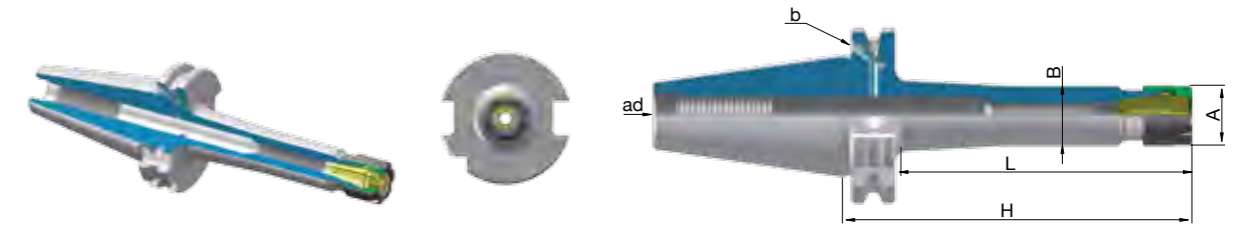

PORTAPINZA ER MINI - COLLET CHUCK ER MINI - SKB50

Cod.	TYPE	CAPACITÀ RANGE	AT2		G6.3/15000		AD/B	
			A	B	L	H	A	B
SKB.50.130.ER16M	TCB50 H130 ERX16M	1 ÷ 10 mm	22	22	110,9	130		
SKB.50.160.ER16M	TCB50 H160 ERX16M	1 ÷ 10 mm	22	22	140,9	160		
SKB.50.200.ER16M	TCB50 H200 ERX16M	1 ÷ 10 mm	22	22	180,9	200		
SKB.50.130.ER20M	TCB50 H130 ERX20M	1 ÷ 13 mm	28	28	110,9	130		
SKB.50.130.ER25M	TCB50 H130 ERX25M	1 ÷ 16 mm	35	35	110,9	130		
SKB.50.160.ER25M	TCB50 H160 ERX25M	1 ÷ 16 mm	35	35	140,9	160		



PORTAPINZA ER - COLLET CHUCK ER - SK30

Cod.	TYPE	CAPACITÀ RANGE	AT2		G6.3/15000		AD	
			A	H	A	H	A	H
SK.30.63.ER16	TC30 H 63 ERX16	1 ÷ 10 mm	32	63				
SK.30.100.ER16	TC30 H100 ERX16	1 ÷ 10 mm	32	100				
SK.30.63.ER20	TC30 H 63 ERX20	1 ÷ 13 mm	35	63				
SK.30.63.ER25	TC30 H 63 ERX25	1 ÷ 16 mm	42	63				
SK.30.90.ER25	TC30 H 90 ERX25	1 ÷ 16 mm	42	90				
SK.30.63.ER32	TC30 H 63 ERX32	2 ÷ 20 mm	50	63				
SK.30.100.ER32	TC30 H100 ERX32	2 ÷ 20 mm	50	100				



PORTAPINZA ER - COLLET CHUCK ER - SKB40

Cod.	TYPE	CAPACITÀ RANGE	AD/B	
			A	H
SKB.40.70.ER16	TCB40 H 70 ERX16	1 ÷ 10 mm	32	70
SKB.40.100.ER16	TCB40 H100 ERX16	1 ÷ 10 mm	32	100
SKB.40.120.ER16	TCB40 H120 ERX16	1 ÷ 10 mm	32	120
SKB.40.130.ER16	TCB40 H130 ERX16	1 ÷ 10 mm	32	130
SKB.40.150.ER16	TCB40 H150 ERX16	1 ÷ 10 mm	32	150
SKB.40.160.ER16	TCB40 H160 ERX16	1 ÷ 10 mm	32	160
SKB.40.200.ER16	TCB40 H200 ERX16	1 ÷ 10 mm	32	200
SKB.40.70.ER20	TCB40 H 70 ERX20	1 ÷ 13 mm	35	70
SKB.40.100.ER20	TCB40 H100 ERX20	1 ÷ 13 mm	35	100
SKB.40.130.ER20	TCB40 H130 ERX20	1 ÷ 13 mm	35	130
SKB.40.160.ER20	TCB40 H160 ERX20	1 ÷ 13 mm	35	160
SKB.40.70.ER25	TCB40 H 70 ERX25	1 ÷ 16 mm	42	70
SKB.40.100.ER25	TCB40 H100 ERX25	1 ÷ 16 mm	42	100
SKB.40.130.ER25	TCB40 H130 ERX25	1 ÷ 16 mm	42	130
SKB.40.160.ER25	TCB40 H160 ERX25	1 ÷ 16 mm	42	160
SKB.40.200.ER25	TCB40 H200 ERX25	1 ÷ 16 mm	42	200
SKB.40.47.ER32	TCB40 H 47 ERX32	2 ÷ 20 mm	50	47
SKB.40.70.ER32	TCB40 H 70 ERX32	2 ÷ 20 mm	50	70
SKB.40.100.ER32	TCB40 H100 ERX32	2 ÷ 20 mm	50	100
SKB.40.130.ER32	TCB40 H130 ERX32	2 ÷ 20 mm	50	130
SKB.40.160.ER32	TCB40 H160 ERX32	2 ÷ 20 mm	50	160
SKB.40.200.ER32	TCB40 H200 ERX32	2 ÷ 20 mm	50	200
SKB.40.70.ER40	TCB40 H 70 ERX40	3 ÷ 26 mm	63	70
SKB.40.100.ER40	TCB40 H100 ERX40	3 ÷ 26 mm	63	100
SKB.40.130.ER40	TCB40 H130 ERX40	3 ÷ 26 mm	63	130
SKB.40.160.ER40	TCB40 H160 ERX40	3 ÷ 26 mm	63	160
SKB.40.200.ER40	TCB40 H200 ERX40	3 ÷ 26 mm	63	200



PORTAPINZA ER - COLLET CHUCK ER - SKB45

Cod.	TYPE	CAPACITÀ RANGE	AD/B	
			A	H
SKB.45.80.ER32	TCB45 H80 ERX32	2 ÷ 20 mm	50	80
SKB.45.100.ER32	TCB45 H100 ERX32	2 ÷ 20 mm	50	100
SKB.45.80.ER40	TCB45 H80 ERX40	3 ÷ 26 mm	63	80



PORTAPINZA ER - COLLET CHUCK ER - SKB50

Cod.	TYPE	CAPACITÀ RANGE	AD/B	
			A	H
SKB.50.100.ER16	TCB50 H100 ERX16	1 ÷ 10 mm	32	100
SKB.50.160.ER16	TCB50 H160 ERX16	1 ÷ 10 mm	32	160
SKB.50.200.ER16	TCB50 H200 ERX16	1 ÷ 10 mm	32	200
SKB.50.100.ER20	TCB50 H100 ERX20	1 ÷ 13 mm	35	100
SKB.50.160.ER20	TCB50 H160 ERX20	1 ÷ 13 mm	35	160
SKB.50.80.ER25	TCB50 H 80 ERX25	1 ÷ 16 mm	42	80
SKB.50.100.ER25	TCB50 H100 ERX25	1 ÷ 16 mm	42	100
SKB.50.130.ER25	TCB50 H130 ERX25	1 ÷ 16 mm	42	130
SKB.50.160.ER25	TCB50 H160 ERX25	1 ÷ 16 mm	42	160
SKB.50.200.ER25	TCB50 H200 ERX25	1 ÷ 16 mm	42	200
SKB.50.80.ER32	TCB50 H 80 ERX32	2 ÷ 20 mm	50	80
SKB.50.100.ER32	TCB50 H100 ERX32	2 ÷ 20 mm	50	100
SKB.50.130.ER32	TCB50 H130 ERX32	2 ÷ 20 mm	50	130
SKB.50.160.ER32	TCB50 H160 ERX32	2 ÷ 20 mm	50	160
SKB.50.200.ER32	TCB50 H200 ERX32	2 ÷ 20 mm	50	200
SKB.50.250.ER32	TCB50 H250 ERX32	2 ÷ 20 mm	50	250
SKB.50.80.ER40	TCB50 H 80 ERX40	3 ÷ 30 mm	63	80
SKB.50.100.ER40	TCB50 H100 ERX40	3 ÷ 30 mm	63	100
SKB.50.130.ER40	TCB50 H130 ERX40	3 ÷ 30 mm	63	130
SKB.50.160.ER40	TCB50 H160 ERX40	3 ÷ 30 mm	63	160
SKB.50.200.ER40	TCB50 H200 ERX40	3 ÷ 30 mm	63	200
SKB.50.100.ER50	TCB50 H100 ERX50	6 ÷ 34 mm	78	100
SKB.50.130.ER50	TCB50 H130 ERX50	6 ÷ 34 mm	78	130
SKB.50.160.ER50	TCB50 H160 ERX50	6 ÷ 34 mm	78	160

Fig.1

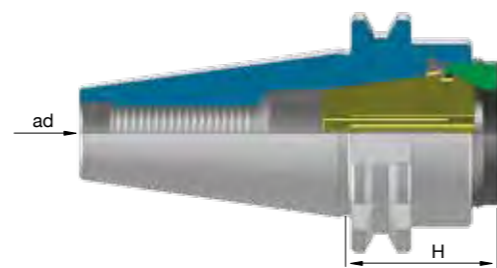
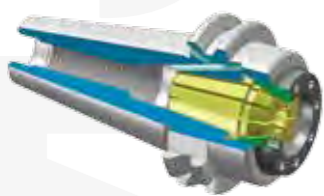
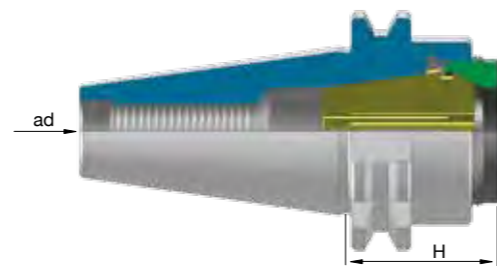

Fig.2



PORTAPINZA ER EXTRACORTO - SHORTS COLLET CHUCK ER - SK40 - SK50

Cod.	TYPE	CAPACITÀ RANGE	AT2 G6.3/15000 AD	
				H
SK.40.21.ER25	TC40 H21 ERX25	1 ÷ 16 mm		21
SK.40.21.ER32	TC40 H21 ERX32	2 ÷ 20 mm		21
SK.50.21.ER32	TC50 H21 ERX32	2 ÷ 20 mm		21

FORNIBILI CON GHIERA CON FILETTO ESTERNO FORMA A CON FORI (Fig.1) E CON ESAGONO (Fig.2)
 AVAILABLE WITH EXTERNALLY THREADED NUTS (Fig.1) AND EXTERNALLY THREADEXAGONAL NUTS (Fig.2)

Fig.1

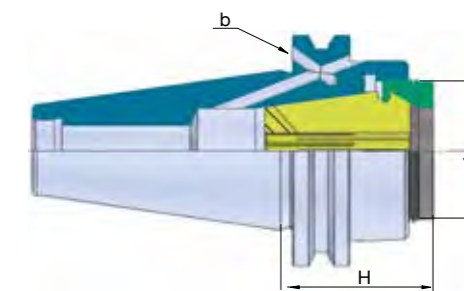
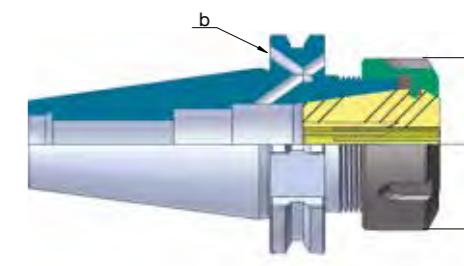

Fig.2



PORTAPINZA ER EXTRACORTO - SHORTS COLLET CHUCK ER - SKB40 - SKB50

Cod.	TYPE	CAPACITÀ RANGE	AT2 G6.3/15000 AD/B	
			A	H
SKB.40.40.ER32	TCB40 H40 ERX32	2 ÷ 20 mm	Hex 32	40
SKB.40.47.ER32	TCB40 H47 ERX32	2 ÷ 20 mm	40	47
SKB.50.40.ER32	TCB50 H40 ERX32	2 ÷ 20 mm	Hex 32	40
SKB.50.47.ER32	TCB50 H47 ERX32	2 ÷ 20 mm	40	47

FORNIBILI CON GHIERA CON FILETTO ESTERNO FORMA A CON FORI (Fig.1), CON ESAGONO E CON GHIERA STANDARD (Fig.2)
 AVAILABLE WITH EXTERNALLY THREADED NUTS (Fig.1), EXTERNALLY THREADEXAGONAL NUTS AND STANDARD CLAMPING NUT (Fig.2)



CASSETTA MANDRINO PORTAPINZE - COLLET CHUCKS KIT

Cod.	Portapinze	Pinze nella serie	Chiave
KIT578	TCB40 H70 ERX32	ERX32: Ø 3 ÷ 20 progress. 1,0 mm - 18 pinze	ERX32 STAND
KIT579	TCB40 H70 ERX40	ERX40: Ø 4 ÷ 26 progress. 1,0 mm - 23 pinze	ERX40 STAND
KIT580	TCB50 H80 ERX32	ERX32: Ø 3 ÷ 20 progress. 1,0 mm - 18 pinze	ERX32 STAND
KIT581	TCB50 H80 ERX40	ERX40: Ø 4 ÷ 26 progress. 1,0 mm - 23 pinze	ERX40 STAND

PORTAPINZA EOC DIN6388

COLLET CHUCK FOR EOC DIN6388

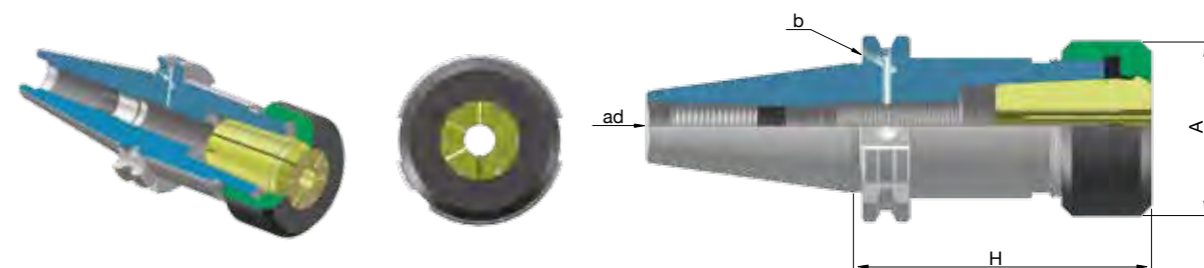
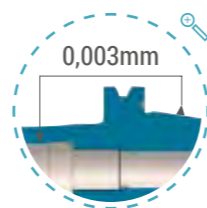

PORTAPINZA PER EOC - COLLET CHUCK FOR EOC - SKB40

Cod.	TYPE	CAPACITÀ RANGE	AD/B	
			A	H
SKB.40.70.EOC16	TCB40 H 70 EOC16	2 ÷ 16 mm	43	70
SKB.40.100.EOC16	TCB40 H100 EOC16	2 ÷ 16 mm	43	100
SKB.40.70.EOC25	TCB40 H 70 EOC25	2 ÷ 25 mm	60	70
SKB.40.100.EOC25	TCB40 H100 EOC25	2 ÷ 25 mm	60	100
SKB.40.90.EOC32	TCB40 H 90 EOC32	4 ÷ 32 mm	72	90

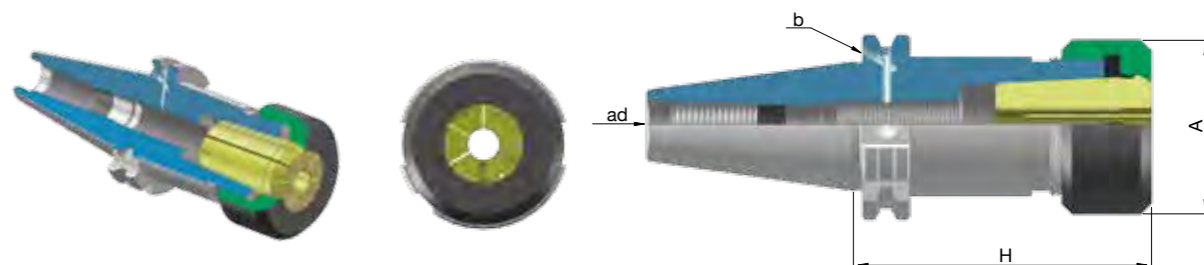

PORTAPINZA PER EOC - COLLET CHUCK FOR EOC - SKB50

Cod.	TYPE	CAPACITÀ RANGE	AD/B	
			A	H
SKB.50.70.EOC16	TCB50 H 70 EOC16	2 ÷ 16 mm	43	70
SKB.50.70.EOC25	TCB50 H 70 EOC25	2 ÷ 25 mm	60	70
SKB.50.80.EOC32	TCB50 H 80 EOC32	4 ÷ 32 mm	72	80
SKB.50.100.EOC32	TCB50 H100 EOC32	4 ÷ 32 mm	72	100

PORTAPINZA PER EOC - COLLET CHUCK FOR EOC - SK30

Cod.	TYPE	CAPACITÀ RANGE	AD	
			A	H
SK.30.60.EOC16	TC30 H60 EOC16	2 ÷ 16 mm	43	60
SK.30.80.EOC25	TC30 H80 EOC25	2 ÷ 25 mm	60	80

PER FRESE WELDON

END MILL HOLDERS

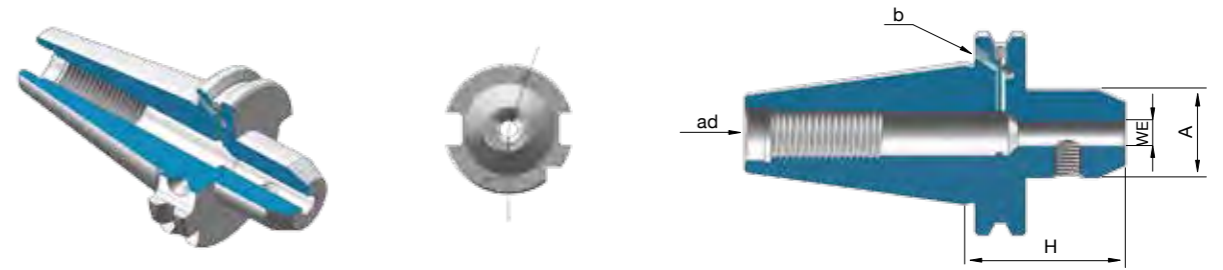
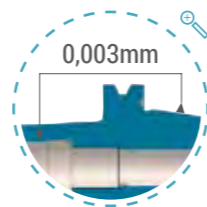

PER FRESE WELDON - END MILL HOLDERS - SKB40

Cod.	TYPE	AT2	G6.3/15000	AD/B
		A	H	WE
SKB.40.200.WE6	TCB40 H200 WE6	25	200	6
SKB.40.50.WE8	TCB40 H 50 WE8	28	50	8
SKB.40.100.WE8	TCB40 H100 WE8	28	100	8
SKB.40.130.WE8	TCB40 H130 WE8	28	130	8
SKB.40.160.WE8	TCB40 H160 WE8	28	160	8
SKB.40.200.WE8	TCB40 H200 WE8	28	200	8
SKB.40.50.WE10	TCB40 H 50 WE10	35	50	10
SKB.40.100.WE10	TCB40 H100 WE10	35	100	10
SKB.40.130.WE10	TCB40 H130 WE10	35	130	10
SKB.40.160.WE10	TCB40 H160 WE10	35	160	10
SKB.40.200.WE10	TCB40 H200 WE10	35	200	10
SKB.40.50.WE12	TCB40 H 50 WE12	42	50	12
SKB.40.100.WE12	TCB40 H100 WE12	42	100	12
SKB.40.130.WE12	TCB40 H130 WE12	42	130	12
SKB.40.160.WE12	TCB40 H160 WE12	42	160	12
SKB.40.200.WE12	TCB40 H200 WE12	42	200	12
SKB.40.50.WE14	TCB40 H 50 WE14	44	50	14
SKB.40.100.WE14	TCB40 H100 WE14	44	100	14
SKB.40.130.WE14	TCB40 H130 WE14	44	130	14
SKB.40.160.WE14	TCB40 H160 WE14	44	160	14
SKB.40.200.WE14	TCB40 H200 WE14	44	200	14
SKB.40.63.WE16	TCB40 H 63 WE16	48	63	16
SKB.40.100.WE16	TCB40 H100 WE16	48	100	16
SKB.40.130.WE16	TCB40 H130 WE16	48	130	16
SKB.40.160.WE16	TCB40 H160 WE16	48	160	16
SKB.40.200.WE16	TCB40 H200 WE16	48	200	16

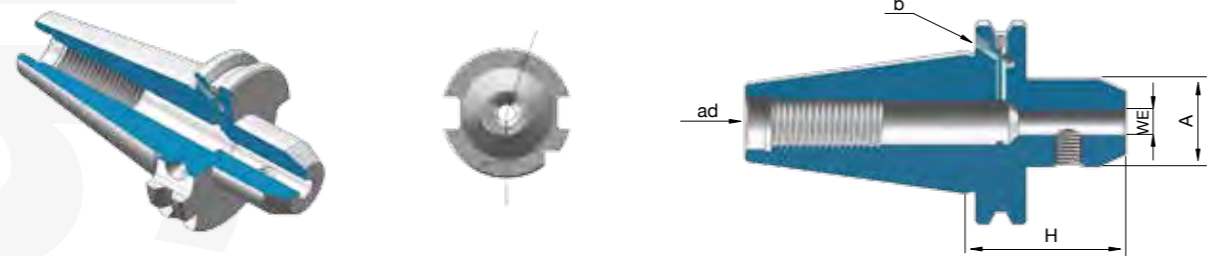

PER FRESE WELDON - END MILL HOLDERS - SKB40

Cod.	TYPE	AT2	G6.3/15000	AD/B
		A	H	WE
SKB.40.50.WE6	TCB40 H 50 WE6	25	50	6
SKB.40.100.WE6	TCB40 H100 WE6	25	100	6
SKB.40.130.WE6	TCB40 H130 WE6	25	130	6
SKB.40.160.WE6	TCB40 H160 WE6	25	160	6

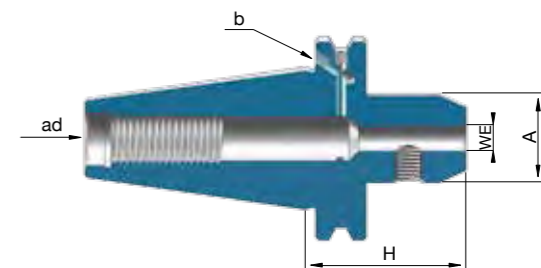
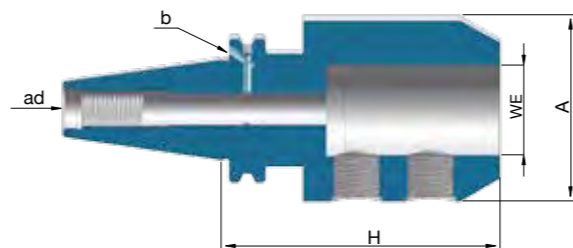
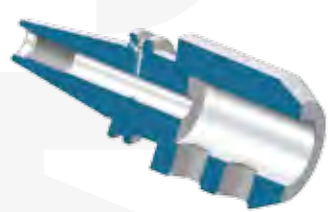

PER FRESE WELDON - END MILL HOLDERS - SKB40

Cod.	TYPE	AT2 G6.3/15000 AD/B		
		A	H	WE
SKB.40.63.WE18	TCB40 H 63 WE18	50	63	18
SKB.40.100.WE18	TCB40 H100 WE18	50	100	18
SKB.40.130.WE18	TCB40 H130 WE18	50	130	18
SKB.40.160.WE18	TCB40 H160 WE18	50	160	18
SKB.40.200.WE18	TCB40 H200 WE18	50	200	18
SKB.40.63.WE20	TCB40 H 63 WE20	52	63	20
SKB.40.100.WE20	TCB40 H100 WE20	52	100	20
SKB.40.130.WE20	TCB40 H130 WE20	52	130	20
SKB.40.160.WE20	TCB40 H160 WE20	52	160	20
SKB.40.200.WE20	TCB40 H200 WE20	52	200	20
SKB.40.100.WE25	TCB40 H100 WE25	65	100	25
SKB.40.130.WE25	TCB40 H130 WE25	65	130	25
SKB.40.160.WE25	TCB40 H160 WE25	65	160	25
SKB.40.100.WE32	TCB40 H100 WE32	72	100	32
SKB.40.130.WE32	TCB40 H130 WE32	72	130	32
SKB.40.160.WE32	TCB40 H160 WE32	72	160	32
SKB.40.120.WE40	TCB40 H120 WE40	80	120	40

PER FRESE WELDON - END MILL HOLDERS - SKB50

Cod.	TYPE	AT2 G6.3/15000 AD/B		
		A	H	WE
SKB.50.63.WE6	TCB50 H 63 WE 6	25	63	6
SKB.50.100.WE6	TCB50 H100 WE 6	25	100	6
SKB.50.130.WE6	TCB50 H130 WE 6	25	130	6
SKB.50.160.WE6	TCB50 H160 WE 6	25	160	6
SKB.50.200.WE6	TCB50 H200 WE 6	25	200	6
SKB.50.63.WE8	TCB50 H 63 WE 8	28	63	8
SKB.50.100.WE8	TCB50 H100 WE 8	28	100	8
SKB.50.130.WE8	TCB50 H130 WE 8	28	130	8
SKB.50.160.WE8	TCB50 H160 WE 8	28	160	8
SKB.50.200.WE8	TCB50 H200 WE 8	28	200	8
SKB.50.63.WE10	TCB50 H 63 WE10	35	63	10
SKB.50.100.WE10	TCB50 H100 WE10	35	100	10
SKB.50.130.WE10	TCB50 H130 WE10	35	130	10
SKB.50.160.WE10	TCB50 H160 WE10	35	160	10
SKB.50.200.WE10	TCB50 H200 WE10	35	200	10
SKB.50.63.WE12	TCB50 H 63 WE12	42	63	12
SKB.50.100.WE12	TCB50 H100 WE12	42	100	12
SKB.50.130.WE12	TCB50 H130 WE12	42	130	12
SKB.50.160.WE12	TCB50 H160 WE12	42	160	12
SKB.50.200.WE12	TCB50 H200 WE12	42	200	12
SKB.50.63.WE14	TCB50 H 63 WE14	44	63	14
SKB.50.100.WE14	TCB50 H100 WE14	44	100	14
SKB.50.130.WE14	TCB50 H130 WE14	44	130	14
SKB.50.160.WE14	TCB50 H160 WE14	44	160	14
SKB.50.200.WE14	TCB50 H200 WE14	44	200	14
SKB.50.63.WE16	TCB50 H 63 WE16	48	63	16
SKB.50.100.WE16	TCB50 H100 WE16	48	100	16
SKB.50.130.WE16	TCB50 H130 WE16	48	130	16
SKB.50.160.WE16	TCB50 H160 WE16	48	160	16
SKB.50.200.WE16	TCB50 H200 WE16	48	200	16
SKB.50.63.WE18	TCB50 H 63 WE18	50	63	18
SKB.50.100.WE18	TCB50 H100 WE18	50	100	18
SKB.50.130.WE18	TCB50 H130 WE18	50	130	18
SKB.50.160.WE18	TCB50 H160 WE18	50	160	18
SKB.50.200.WE18	TCB50 H200 WE18	50	200	18

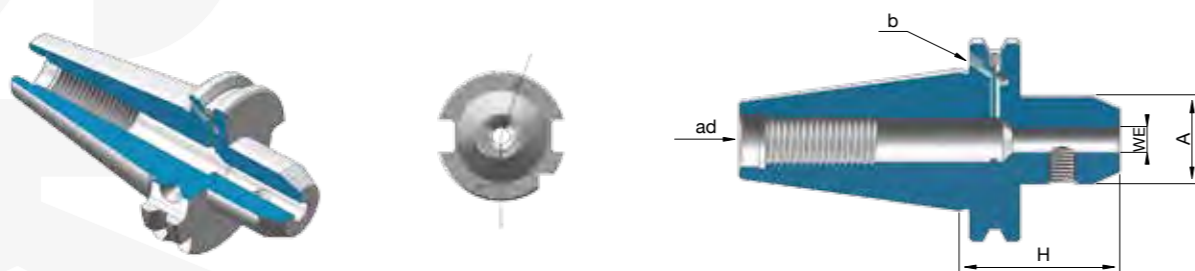

PER FRESE WELDON - END MILL HOLDERS - SKB50

Cod.	TYPE	AT2		
		A	H	WE
SKB.50.63.WE20	TCB50 H 63 WE20	52	63	20
SKB.50.100.WE20	TCB50 H100 WE20	52	100	20
SKB.50.130.WE20	TCB50 H130 WE20	52	130	20
SKB.50.160.WE20	TCB50 H160 WE20	52	160	20
SKB.50.200.WE20	TCB50 H200 WE20	52	200	20
SKB.50.250.WE20	TCB50 H250 WE20	52	250	20
SKB.50.80.WE25	TCB50 H 80 WE25	65	80	25
SKB.50.100.WE25	TCB50 H100 WE25	65	100	25
SKB.50.130.WE25	TCB50 H130 WE25	65	130	25
SKB.50.160.WE25	TCB50 H160 WE25	65	160	25
SKB.50.200.WE25	TCB50 H200 WE25	65	200	25
SKB.50.250.WE25	TCB50 H250 WE25	65	250	25
SKB.50.100.WE32	TCB50 H100 WE32	72	100	32
SKB.50.130.WE32	TCB50 H130 WE32	72	130	32
SKB.50.160.WE32	TCB50 H160 WE32	72	160	32
SKB.50.200.WE32	TCB50 H200 WE32	72	200	32
SKB.50.250.WE32	TCB50 H250 WE32	72	250	32
SKB.50.112.WE40	TCB50 H112 WE40	80	112	40
SKB.50.130.WE40	TCB50 H130 WE40	80	130	40
SKB.50.160.WE40	TCB50 H160 WE40	80	160	40
SKB.50.200.WE40	TCB50 H200 WE40	80	200	40
SKB.50.130.WE50	TCB50 H130 WE50	90	130	50

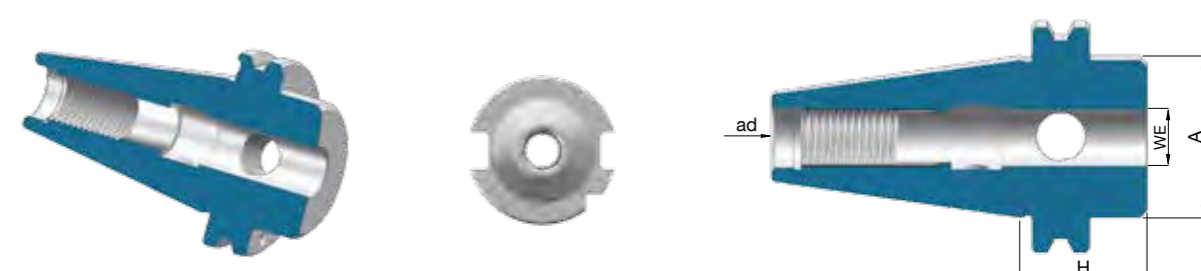

EXTRACORTI PER FRESE WELDON - SHORTS END MILL HOLDERS - SK30

Cod.	TYPE	A	AT2		
			SCREWS	H	WE
SK.30.35.WE16	TC 30 H 35 WE 16	32	M14 x 10	35	16
SK.30.35.WE20	TC 30 H 35 WE 20	36	M16 x 10	35	20



EXTRACORTI PER FRESE WELDON - SHORTS END MILL HOLDERS - SKB40

Cod.	TYPE	A	AT2		
			SCREWS	H	WE
SKB.40.35.WE16	TCB40 H 35 WE16	44,4	M14x16	35	16
SKB.40.35.WE20	TCB40 H 35 WE20	44,4	M16x16	35	20
SKB.40.35.WE25	TCB40 H 35 WE25	44,4	M16x10	35	25
SKB.40.60.WE25	TCB40 H 60 WE25	50	M18x2x12 + M16x1x8	60	25
SKB.40.40.WE32	TCB40 H 40 WE32	72	M20x2x20 + M16x1x8	40	32
SKB.40.70.WE32	TCB40 H 70 WE32	72	M20x2x20 + M16x1x8	70	32

PORTAFRESE FISSI

SHELL END MILL HOLDERS



EXTRACORTI PER FRESE WELDON - SHORTS END MILL HOLDERS - SKB50

Cod.	TYPE	A	SCREWS	AT2	
				G6.3/15000	AD/B
SKB.50.35.WE16	TCB50 H 35 WE16	70	M14x16	35	16
SKB.50.35.WE20	TCB50 H35 WE20	70	M16x16	35	20
SKB.50.35.WE25	TCB50 H35 WE25	70	M8x2x20	35	25
SKB.50.35.WE32	TCB50 H 35 WE32	70	M20x2x20	35	32
SKB.50.35.WE40	TCB50 H 35 WE40	80	M20x2x20	35	40

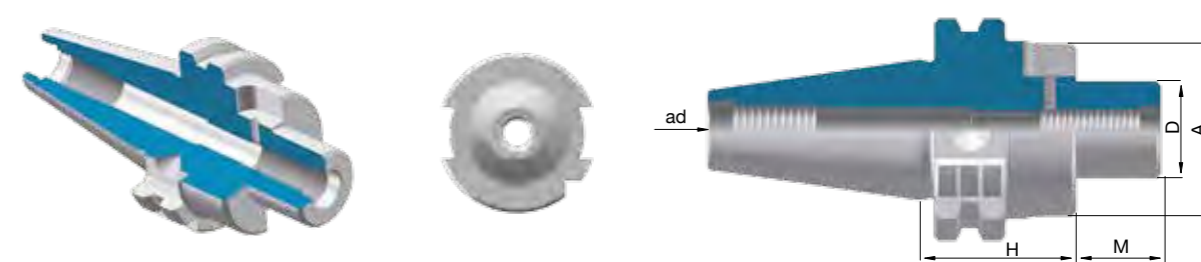
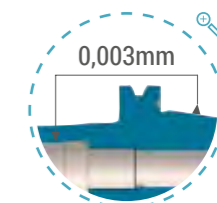

PORTAFRESE FISSI - SHELL END MILL HOLDERS - SK30

Cod.	TYPE	A	D	AT2	
				G6.3/15000	AD
SK.30.35.D16S	TC30 H35 D16S	32	16	17	35
SK.30.35.D22S	TC30 H35 D22S	40	22	19	35
SK.30.60.D27S	TC30 H60 D27S	50	27	21	60
SK.30.60.D32S	TC30 H60 D32S	58	32	24	60

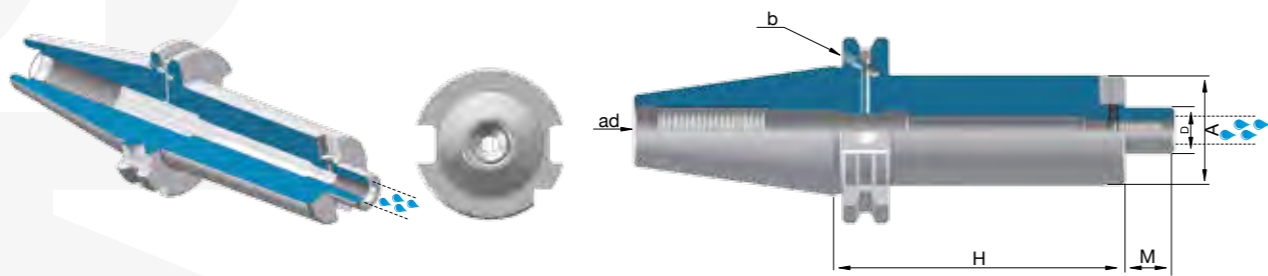

PORTAFRESE FISSI - SHELL END MILL HOLDERS - SKB40

Cod.	TYPE	A	D	AT2		G6.3/15000		AD/B	
				M	H	M	H	M	H
SKB.40.35.D16S	TCB40 H 35 D16S	38	16	17	35				
SKB.40.50.D16S	TCB40 H 50 D16S	38	16	17	50				
SKB.40.100.D16S	TCB40 H100 D16S	38	16	17	100				
SKB.40.130.D16S	TCB40 H130 D16S	38	16	17	130				
SKB.40.160.D16S	TCB40 H160 D16S	38	16	17	160				
SKB.40.200.D16S	TCB40 H200 D16S	38	16	17	200				
SKB.40.35.D22S	TCB40 H 35 D22S	48	22	19	35				
SKB.40.45.D22S	TCB40 H 45 D22S	48	22	19	45				
SKB.40.100.D22S	TCB40 H100 D22S	48	22	19	100				
SKB.40.130.D22S	TCB40 H130 D22S	48	22	19	130				
SKB.40.160.D22S	TCB40 H160 D22S	48	22	19	160				
SKB.40.200.D22S	TCB40 H200 D22S	48	22	19	200				
SKB.40.35.D27S	TCB40 H 35 D27S	58	27	21	35				
SKB.40.50.D27S	TCB40 H 50 D27S	58	27	21	50				
SKB.40.100.D27S	TCB40 H100 D27S	58	27	21	100				
SKB.40.130.D27S	TCB40 H130 D27S	58	27	21	130				
SKB.40.160.D27S	TCB40 H160 D27S	58	27	21	160				
SKB.40.200.D27S	TCB40 H200 D27S	58	27	21	200				
SKB.40.50.D32S	TCB40 H 50 D32S	78	32	24	50				
SKB.40.55.D32S	TCB40 H 55 D32S	78	32	24	55				
SKB.40.100.D32S	TCB40 H100 D32S	78	32	24	100				
SKB.40.130.D32S	TCB40 H130 D32S	78	32	24	130				
SKB.40.160.D32S	TCB40 H160 D32S	78	32	24	160				
SKB.40.200.D32S	TCB40 H200 D32S	78	32	24	200				
SKB.40.50.D40S	TCB40 H 50 D40S	88	40	27	50				
SKB.40.60.D40S	TCB40 H 60 D40S	88	40	27	60				
SKB.40.100.D40S	TCB40 H100 D40S	88	40	27	100				
SKB.40.130.D40S	TCB40 H130 D40S	88	40	27	130				
SKB.40.160.D40S	TCB40 H160 D40S	88	40	27	160				
SKB.40.200.D40S	TCB40 H200 D40S	88	40	27	200				

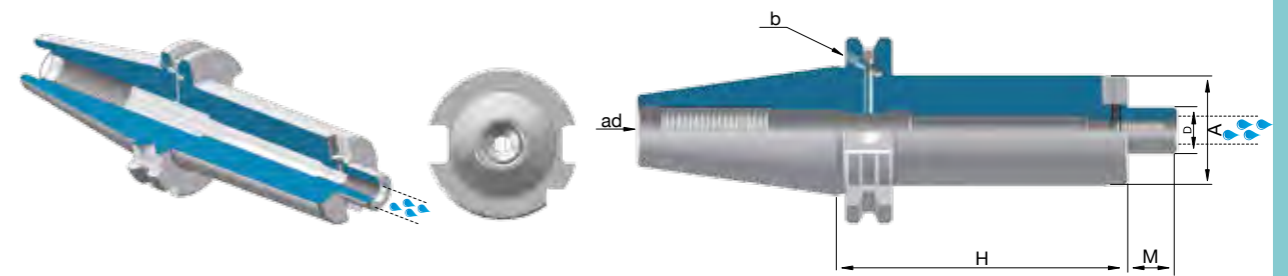

PORTAFRESE FISSI - SHELL END MILL HOLDERS - SKB50

D32Scod.	TYPE	A	D	AT2		G6.3/15000		AD/B	
				M	H	M	H	M	H
SKB.50.35.D16S	TCB50 H 35 D16S	38	16	17	35				
SKB.50.45.D16S	TCB50 H 45 D16S	38	16	17	45				
SKB.50.100.D16S	TCB50 H100 D16S	38	16	17	100				
SKB.50.130.D16S	TCB50 H130 D16S	38	16	17	130				
SKB.50.160.D16S	TCB50 H160 D16S	38	16	17	160				
SKB.50.200.D16S	TCB50 H200 D16S	38	16	17	200				
SKB.50.250.D16S	TCB50 H250 D16S	38	16	17	250				
SKB.50.300.D16S	TCB50 H300 D16S	38	16	17	300				
SKB.50.350.D16S	TCB50 H350 D16S	38	16	17	350				
SKB.50.35.D22S	TCB50 H 35 D22S	48	22	19	35				
SKB.50.45.D22S	TCB50 H 45 D22S	48	22	19	45				
SKB.50.100.D22S	TCB50 H100 D22S	48	22	19	100				
SKB.50.130.D22S	TCB50 H130 D22S	48	22	19	130				
SKB.50.160.D22S	TCB50 H160 D22S	48	22	19	160				
SKB.50.200.D22S	TCB50 H200 D22S	48	22	19	200				
SKB.50.250.D22S	TCB50 H250 D22S	48	22	19	250				
SKB.50.300.D22S	TCB50 H300 D22S	48	22	19	300				
SKB.50.350.D22S	TCB50 H350 D22S	48	22	19	350				
SKB.50.400.D22S	TCB50 H400 D22S	48	22	19	400				
SKB.50.35.D27S	TCB50 H 35 D27S	58	27	21	35				
SKB.50.45.D27S	TCB50 H 45 D27S	58	27	21	45				
SKB.50.100.D27S	TCB50 H100 D27S	58	27	21	100				
SKB.50.130.D27S	TCB50 H130 D27S	58	27	21	130				
SKB.50.160.D27S	TCB50 H160 D27S	58	27	21	160				
SKB.50.200.D27S	TCB50 H200 D27S	58	27	21	200				
SKB.50.250.D27S	TCB50 H250 D27S	58	27	21	250				
SKB.50.300.D27S	TCB50 H300 D27S	58	27	21	300				
SKB.50.350.D27S	TCB50 H350 D27S	58	27	21	350				
SKB.50.400.D27S	TCB50 H400 D27S	58	27	21	400				
SKB.50.35.D32S	TCB50 H 35 D32S	78	32	24	35				
SKB.50.50.D32S	TCB50 H 50 D32S	78	32	24	50				
SKB.50.100.D32S	TCB50 H100 D32S	78	32	24	100				
SKB.50.130.D32S	TCB50 H130 D32S	78	32	24	130				
SKB.50.160.D32S	TCB50 H160 D32S	78	32	24	160				
SKB.50.200.D32S	TCB50 H200 D32S	78	32	24	200				
SKB.50.250.D32S	TCB50 H250 D32S	78	32	24	250				
SKB.50.300.D32S	TCB50 H300 D32S	78	32	24	300				
SKB.50.350.D32S	TCB50 H350 D32S	78	32	24	350				

PORTAFRESE COMBINATI

COMBI SHELL END MILL HOLDERS

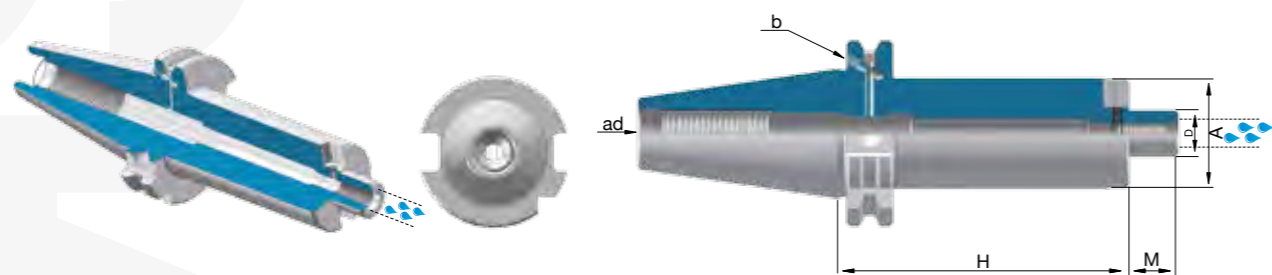

PORTAFRESE FISSI - SHELL END MILL HOLDERS - SKB50

Cod.	TYPE	A	D	AT2		G6.3/15000		AD/B	
SKB.50.35.D40S	TCB50 H 35 D40S	88	40	27	35				
SKB.50.50.D40S	TCB50 H 50 D40S	88	40	27	50				
SKB.50.100.D40S	TCB50 H100 D40S	88	40	27	100				
SKB.50.130.D40S	TCB50 H130 D40S	88	40	27	130				
SKB.50.160.D40S	TCB50 H160 D40S	88	40	27	160				
SKB.50.200.D40S	TCB50 H200 D40S	88	40	27	200				

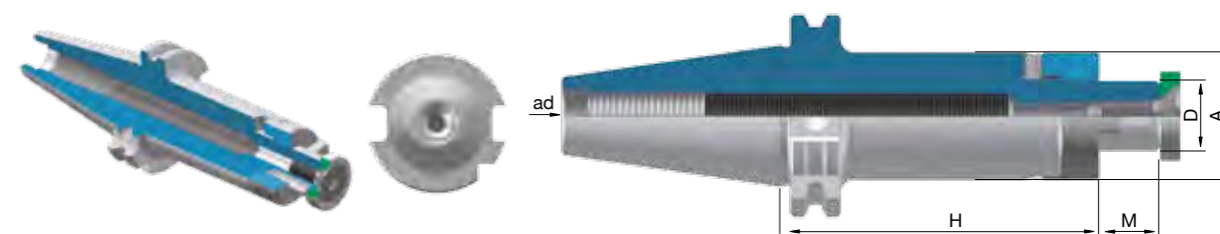
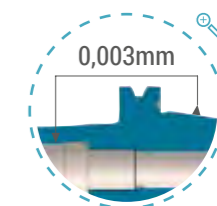

PORTAFRESE COMBINATO - COMBI SHELL END MILL HOLDERS - SK30

Cod.	TYPE	A	D	AT2		G6.3/15000		AD	
SK.30.50.D16C	TC30 H 50 D16C	32	16	17	50				
SK.30.50.D22C	TC30 H 50 D22C	40	22	19	50				
SK.30.55.D27C	TC30 H 55 D27C	48	27	21	55				
SK.30.60.D32C	TC30 H 60 D32C	58	32	24	60				

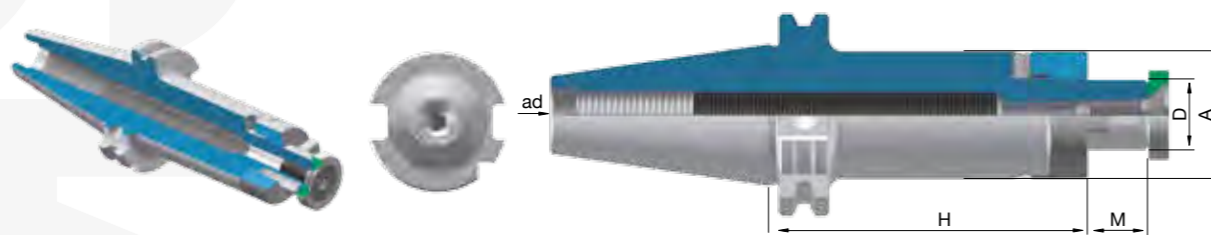

PORTAFRESE COMBINATO - COMBI SHELL END MILL HOLDERS - SK40

Cod.	TYPE	A	D	M	H	AT2	G6.3/15000	AD
SK.40.55.D16C	TC40 H 55 D16C	32	16	17	55			
SK.40.100.D16C	TC40 H100 D16C	32	16	17	100			
SK.40.55.D22C	TC40 H 55 D22C	40	22	19	55			
SK.40.100.D22C	TC40 H100 D22C	40	22	19	100			
SK.40.55.D27C	TC40 H 55 D27C	48	27	21	55			
SK.40.100.D27C	TC40 H100 D27C	48	27	21	100			
SKB.40.60.D32C	TC40 H60 D32C	58	34	24	60			
SK.40.100.D32C	TC40 H100 D32C	58	32	24	100			
SKB.40.60.D40C	TC40 H60 D40C	70	40	27	60			
SK.40.100.D40C	TC40 H100 D40C	70	40	27	100			

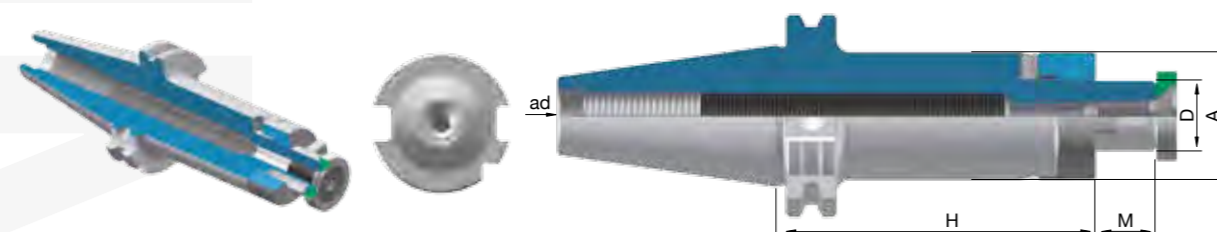

PORTAFRESE COMBINATO - COMBI SHELL END MILL HOLDERS - SK50

Cod.	TYPE	A	D	M	H	AT2	G6.3/15000	AD
SK.50.55.D16C	TC50 H 55 D16C	32	16	17	55			
SK.50.100.D16C	TC50 H100 D16C	32	16	17	100			
SK.50.55.D22C	TC50 H 55 D22C	40	22	19	55			
SK.50.100.D22C	TC50 H100 D22C	40	22	19	100			
SK.50.55.D27C	TC50 H 55 D27C	48	27	21	55			
SK.50.100.D27C	TC50 H100 D27C	48	27	21	100			
SK.50.55.D32C	TC50 H 55 D32C	58	32	24	55			
SK.50.100.D32C	TC50 H100 D32C	58	32	24	100			
SK.50.55.D40C	TC50 H 55 D40C	70	40	27	55			
SK.50.100.D40C	TC50 H100 D40C	70	40	27	100			
SK.50.70.D50C	TC50 H 70 D50C	90	50	30	70			

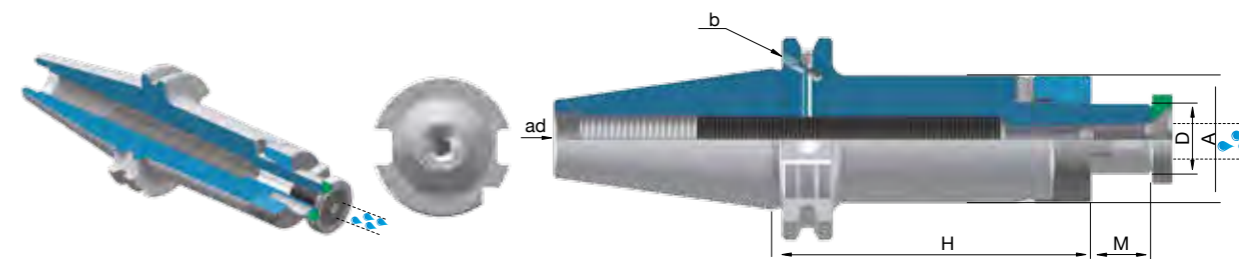

PORTAFRESE COMBINATO - COMBI SHELL END MILL HOLDERS - SKB40

Cod.	TYPE	A	D	M	H	AT2	G6.3/15000	AD/B
SKB.40.55.D16C	TCB40 H 55 D16C	32	16	17	55			
SKB.40.100.D16C	TCB40 H100 D16C	32	16	17	100			
SKB.40.130.D16C	TCB40 H130 D16C	32	16	17	130			
SKB.40.160.D16C	TCB40 H160 D16C	32	16	17	160			
SKB.40.200.D16C	TCB40 H200 D16C	32	16	17	200			
SKB.40.55.D22C	TCB40 H 55 D22C	40	22	19	55			
SKB.40.100.D22C	TCB40 H100 D22C	40	22	19	100			
SKB.40.130.D22C	TCB40 H130 D22C	40	22	19	130			
SKB.40.160.D22C	TCB40 H160 D22C	40	22	19	160			
SKB.40.200.D22C	TCB40 H200 D22C	40	22	19	200			
SKB.40.55.D27C	TCB40 H 55 D27C	48	27	21	55			
SKB.40.100.D27C	TCB40 H100 D27C	48	27	21	100			
SKB.40.130.D27C	TCB40 H130 D27C	48	27	21	130			
SKB.40.160.D27C	TCB40 H160 D27C	48	27	21	160			
SKB.40.200.D27C	TCB40 H200 D27C	48	27	21	200			
SKB.40.60.D32C	TCB40 H 60 D32C	58	32	24	60			
SKB.40.100.D32C	TCB40 H100 D32C	58	32	24	100			
SKB.40.130.D32C	TCB40 H130 D32C	58	32	24	130			
SKB.40.160.D32C	TCB40 H160 D32C	58	32	24	160			
SKB.40.200.D32C	TCB40 H200 D32C	58	32	24	200			
SKB.40.60.D40C	TCB40 H 60 D40C	70	40	27	60			
SKB.40.100.D40C	TCB40 H100 D40C	70	40	27	100			
SKB.40.130.D40C	TCB40 H130 D40C	70	40	27	130			
SKB.40.160.D40C	TCB40 H160 D40C	70	40	27	160			
SKB.40.200.D40C	TCB40 H200 D40C	70	40	27	200			

PORTA PUNTE AUTOSERRANTI CON CHIAVE A SETTORE

DRILL CHUCKS WITH HOOK WRENCH

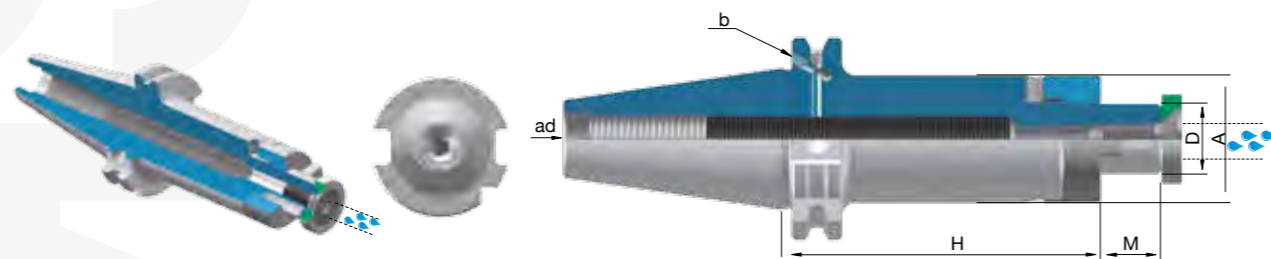

PORTAFRESE COMBINATO - COMBI SHELL END MILL HOLDERS - SKB50

Cod.	TYPE	A	D	AT2		G6.3/15000		AD/B	
SKB.50.55.D16C	TCB50 H 55 D16C	32	16			17		55	
SKB.50.100.D16C	TCB50 H100 D16C	32	16			17		100	
SKB.50.130.D16C	TCB50 H130 D16C	32	16			17		130	
SKB.50.160.D16C	TCB50 H160 D16C	32	16			17		160	
SKB.50.55.D22C	TCB50 H 55 D22C	40	22			19		55	
SKB.50.100.D22C	TCB50 H100 D22C	40	22			19		100	
SKB.50.130.D22C	TCB50 H130 D22C	40	22			19		130	
SKB.50.160.D22C	TCB50 H160 D22C	40	22			19		160	
SKB.50.55.D27C	TCB50 H 55 D27C	48	27			21		55	
SKB.50.100.D27C	TCB50 H100 D27C	48	27			21		100	
SKB.50.130.D27C	TCB50 H130 D27C	48	27			21		130	
SKB.50.160.D27C	TCB50 H160 D27C	48	27			21		160	
SKB.50.55.D32C	TCB50 H 55 D32C	58	32			24		55	
SKB.50.100.D32C	TCB50 H100 D32C	58	32			24		100	
SKB.50.130.D32C	TCB50 H130 D32C	58	32			24		130	
SKB.50.160.D32C	TCB50 H160 D32C	58	32			24		160	
SKB.50.55.D40C	TCB50 H 55 D40C	70	40			27		55	
SKB.50.100.D40C	TCB50 H100 D40C	70	40			27		100	
SKB.50.130.D40C	TCB50 H130 D40C	70	40			27		130	
SKB.50.160.D40C	TCB50 H160 D40C	70	40			27		160	

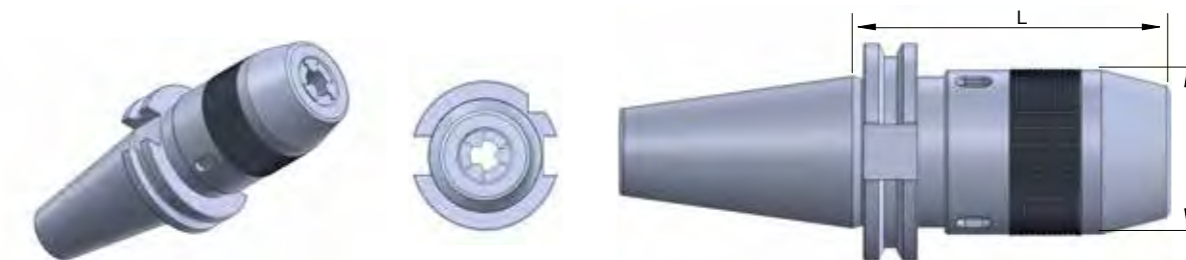

AUTOSERRANTI CON CHIAVE A SETTORE - DRILL CHUCK - SK30

Cod.	TYPE	CAPACITÀ RANGE	AT2		G6.3/12000		AD	
SK.30.80.DCK8	TC30 H 80 DCK8	1 ÷ 8 mm			37		80	

PORTA PUNTE AUTOSERRANTI CON CHIAVE ESAGONALE

HEX KEY LOCK DRILL CHUCK

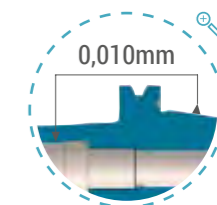

AUTOSERRANTI CON CHIAVE A SETTORE - DRILL CHUCK - SK40

Cod.	TYPE	CAPACITÀ RANGE	AT2		G6.3/12000		AD	
			A	L	A	L	A	L
SK.40.75.DCK8	TC40 H 75 DCK8	1 ÷ 8 mm	37	75				
SK.40.100.DCK13	TC40 H100 DCK13	1 ÷ 13 mm	50	100				
SK.40.115.DCK16	TC40 H115 DCK16	3 ÷ 16 mm	58	115				

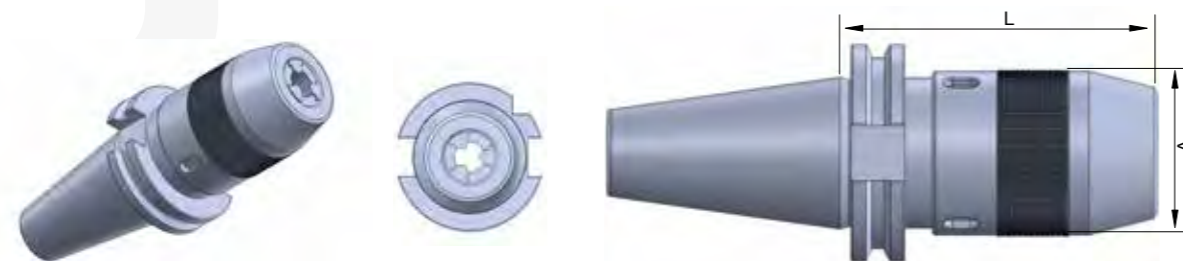

AUTOSERRANTI CON CHIAVE A SETTORE - DRILL CHUCK - SK50

Cod.	TYPE	CAPACITÀ RANGE	AT2		G6.3/12000		AD	
			A	L	A	L	A	L
SK.50.88.DCK13	TC50 H88 DCK13	1 ÷ 13 mm	88	88				
SK.50.90.DCK16	TC50 H90 DCK16	3 ÷ 16 mm	90	90				

RICAMBI AUTOSERRANTI CHIAVE A SETTORE - SPARE PARTS FOR DRILL CHUCK

Cod.	TYPE
RIC.DCK8	RICAMBI PER / SPARE PARTS FOR DCK8
RIC.DCK13	RICAMBI PER / SPARE PARTS FOR DCK13
RIC.DCK16	RICAMBI PER / SPARE PARTS FOR DCK16

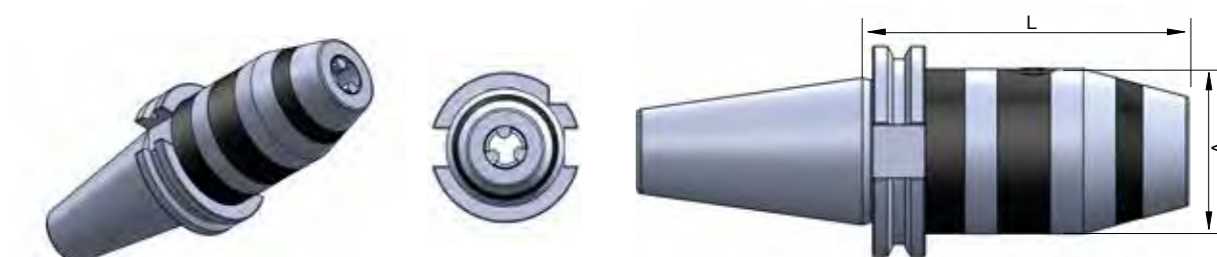

PORTAPUNTE CON CHIAVE ESAGONALE - DRILL CHUCK WITH HEX KEY - SK40

Cod.	TYPE	CAPACITÀ RANGE	AT2		G6.3/12000		AD	
			A	L	A	L	A	L
SK.40.90.HD13	TC40 H90 HD13	1 ÷ 13 mm	50	90				
SK.40.95.HD16	TC40 H95 HD16	3 ÷ 16 mm	58	95				

CONO MORSE PUNTE / FRESE

MORSE TAPER ADAPTERS FOR DRILLS / FOR MILLS

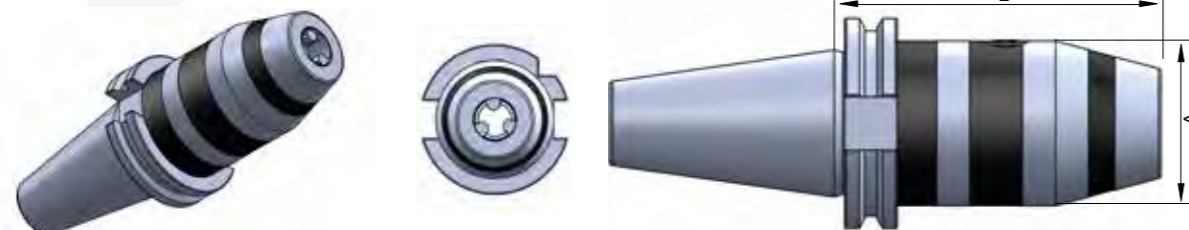

PORTAPUNTE CON CHIAVE ESAGONALE - DRILL CHUCK WITH HEX KEY - SK50

Cod.	TYPE	CAPACITÀ RANGE	AT2		G6.3/12000		AD	
			A	L	A	L	A	L
SK.50.90.HD13	TC50 H90 HD13	1 ÷ 13 mm	90	90				
SK.50.95.HD16	TC50 H95 HD16	3 ÷ 16 mm	95	95				

RICAMBI PORTAPUNTE - SPARE PARTS FOR DRILL CHUCK HEX KEY

Cod.	TYPE
RIC.HD13	RICAMBI PER/SPARE PARTS FOR HD13
RIC.HD16	RICAMBI PER/SPARE PARTS FOR HD16



CONO MORSE PER PUNTE - MORSE TAPER FOR DRILLS - SK30

Cod.	TYPE	AT2		G6.3/15000		AD	
		A	L	A	L	A	L
SK.30.50.CM1P	TC 30 H 50 CM1 P	25	31	50			
SK.30.65.CM2P	TC 30 H 65 CM2 P	32	46	65			
SK.30.80.CM3P	TC 30 H 80 CM3 P	40	61	80			



CONO MORSE PER PUNTE - MORSE TAPER FOR DRILLS - SK40

Cod.	TYPE	AT2 G6.3/15000 AD		
		A	L	H
SK.40.50.CM1P	TC4 0 H 50 CM1 P	25	31	50
SK.40.50.CM2P	TC 40 H 50 CM2 P	32	31	50
SK.40.117.CM2P	TC 40 H 117 CM2 P	32	98	117
SK.40.70.CM3P	TC 40 H 70 CM3 P	40	51	70
SK.40.133.CM3P	TC 40 H 133 CM3 P	40	114	133
SK.40.95.CM4P	TC 40 H 95 CM4 P	48	76	95
SK.40.156.CM4P	TC 40 H 156 CM4 P	48	137	156



CONO MORSE PER PUNTE - MORSE TAPER FOR DRILLS - SKB40

Cod.	TYPE	AT2 G6.3/15000 AD/B	
		A	H
SKB.40.50.CM1P	TCB40 H 50 CM1 P	25	50
SKB.40.50.CM2P	TCB40 H 50 CM2 P	32	50
SKB.40.70.CM3P	TCB40 H 70 CM3 P	40	70
SKB.40.95.CM4P	TCB40 H 95 CM4 P	48	95

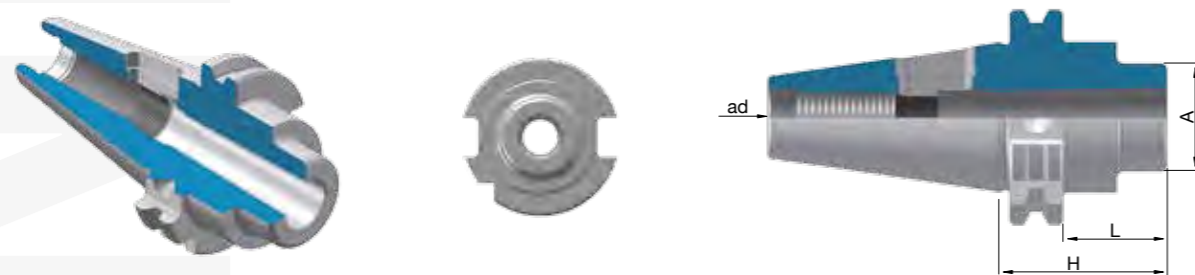

CONO MORSE PER PUNTE - MORSE TAPER FOR DRILLS - SK50

Cod.	TYPE	AT2 G6.3/15000 AD		
		A	L	H
SK.50.45.CM1P	TC 50 H 45 CM1 P	25	26	45
SK.50.120.CM1P	TC 50 H120 CM1 P	25	101	120
SK.50.60.CM2P	TC 50 H 60 CM2 P	32	41	60
SK.50.135.CM2P	TC 50 H135 CM2 P	32	116	135
SK.50.65.CM3P	TC 50 H 65 CM3 P	40	46	65
SK.50.155.CM3P	TC 50 H155 CM3 P	40	136	155
SK.50.95.CM4P	TC 50 H 95 CM4 P	48	76	95
SK.50.180.CM4P	TC 50 H 180 CM4 P	48	161	180
SK.50.105.CM5P	TC 50 H105 CM5 P	63	86	105
SK.50.215.CM5P	TC 50 H 215 CM5 P	63	196	215



CONO MORSE PER PUNTE - MORSE TAPER FOR DRILLS - SKB50

Cod.	TYPE	AT2 G6.3/15000 AD/B	
		A	H
SKB.50.45.CM1P	TCB50 H 45 CM1 P	25	45
SKB.50.60.CM2P	TCB50 H 60 CM2 P	32	60
SKB.50.65.CM3P	TCB50 H 65 CM3 P	40	65
SKB.50.95.CM4P	TCB50 H 95 CM4 P	48	95
SKB.50.105.CM5P	TCB50 H105 CM5 P	63	105

STELO TENERO LAVORABILE

BLANK ARBORS

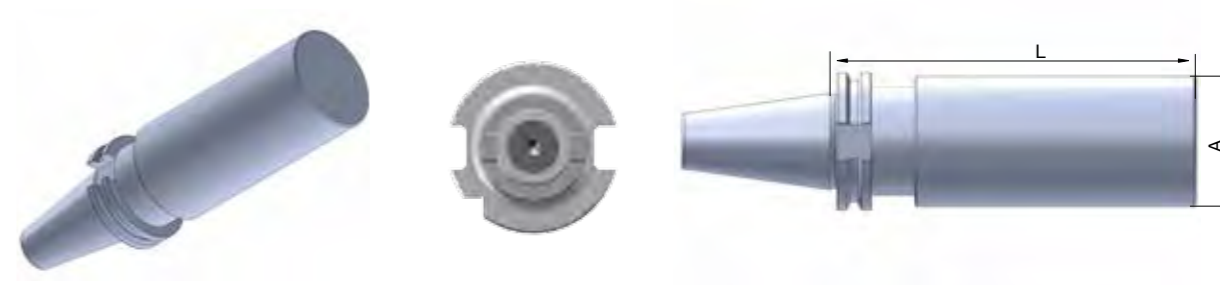

STELO TENERO LAVORABILE - BLANK ARBORS - SK40

Cod.	TYPE	AT2		AD		42HRC	
		A	M	L	H	L	A
SK.40.250.D40BL	TC40 H 250 D40	40		250			
SK.40.250.D63BL	TC40 H 250 D63	63		250			

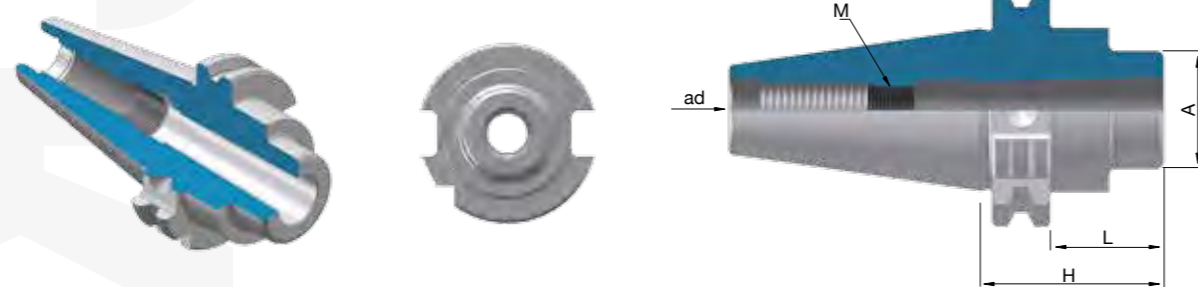

CONO MORSE PER FRESE - MORSE TAPER FOR MILLS - SK40

Cod.	TYPE	AT2		G6.3/15000		AD	
		A	M	L	H	L	H
SK.40.50.CM1F	TC40 H 50 CM1 FV	25	M6	31		50	
SK.40.50.CM2F	TC40 H 50 CM2 FV	32	M10	31		50	
SK.40.70.CM3F	TC40 H 70 CM3 FV	40	M12	51		70	
SK.40.95.CM4F	TC40 H 95 CM4 FV	48	M16	76		95	
SK.40.110.CM4F	TC40 H110 CM4 FV	48	M16	146		110	

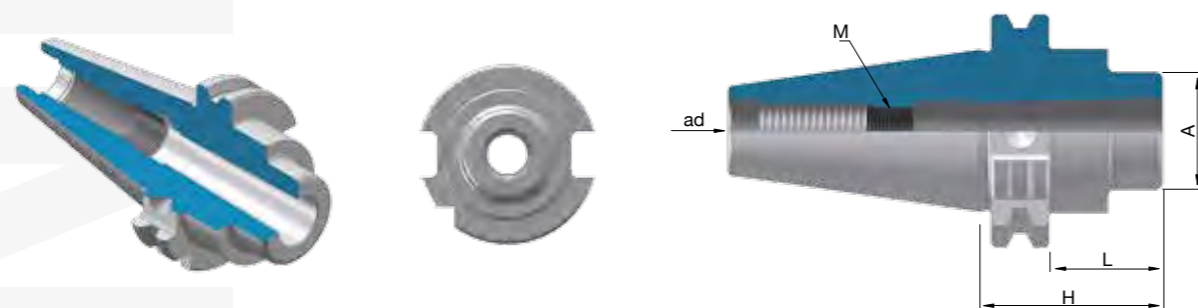

CONO MORSE PER FRESE - MORSE TAPER FOR MILLS - SK50

Cod.	TYPE	AT2		G6.3/15000		AD	
		A	M	L	H	L	H
SK.50.45.CM1F	TC50 H 45 CM1 FV	25	M6	26		45	
SK.50.60.CM2F	TC50 H 60 CM2 FV	32	M10	41		60	
SK.50.65.CM3F	TC50 H 65 CM3 FV	40	M12	46		65	
SK.50.70.CM4F	TC50 H 70 CM4 FV	48	M16	51		70	
SK.50.85.CM4F	TC50 H 85 CM4 FV	48	M16	66		85	
SK.50.100.CM5F	TC50 H 100 CM5 FV	63	M20	81		100	
SK.50.118.CM5F	TC50 H 118 CM5 FV	63	M20	99		118	

BARRA DI CONTROLLO

TEST ARBORS

SK-DIN69871

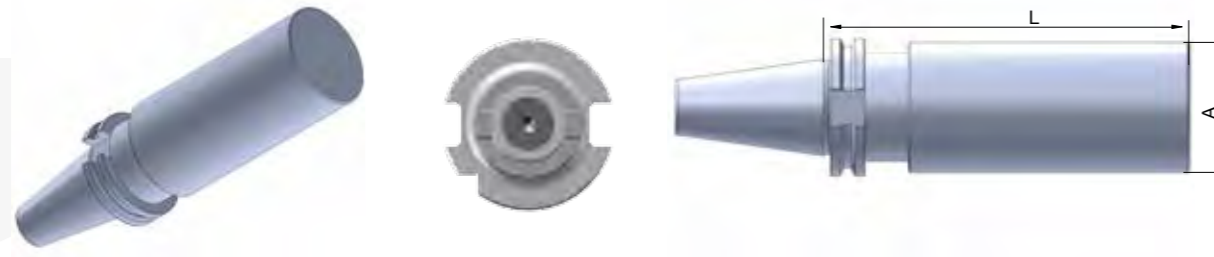

STELO TENERO LAVORABILE - BLANK ARBORS - SK50

Cod.	TYPE			
		AT2	AD	42HRC
		A	L	
SK.50.315.D63BL	TC50 H 315 D63	63	315	
SK.50.315.D97BL	TC50 H 315 D97	97	315	



BARRA DI CONTROLLO - TEST ARBORS - SK30 - SK40 - SK50

Cod.	TYPE		
		AT2	AD
		L	A
SK.30.200.D32	TC30 H 200 D 32	200	32
SK.40.300.D40	TC40 H 300 D 40	300	40
SK.50.300.D50	TC50 H 300 D 50	300	50

FORNITE COMPLETE DI CERTIFICATO E COFANETTO DI LEGNO
PROVIDED WITH WOODEN BOX AND SPECIFIC CERTIFICATE